



# Internal Partition Walls.



## Superglass Acoustic Insulation.

### Acoustic insulation for internal wall systems.

All Superglass acoustic insulation products help reduce the passage of sound, enhancing both comfort and privacy. Furthermore, the flexible nature of the rolls allows for friction fitting installation between studs and in a wide variety of partition types. For fire rated partitions, insulation is to be clamped between Siniat Metal Angle fixed through to head track or soffit. Two fixings per 600mm strip, approx. 300mm apart.

Superglass Products	Minimum Density	Superglass Products	Nominal Density
100mm Multi Acoustic Roll	10kg/m <sup>3</sup>	25mm Acoustic Partition Roll (APR)	18kg/m <sup>3</sup>
		50mm Acoustic Partition Roll (APR)	15kg/m <sup>3</sup>



When specifying acoustic partitions, you need to be confident that you will achieve the required sound performance. Minimising sound transmission between rooms and maximising acoustic comfort for the building's occupants.

A whole system approach to specification is the optimum way to deliver all the acoustic performance you need, with every component working together in a system that's been rigorously tested to perform.

Superglass insulation complements Siniat internal partition systems, with both companies working collaboratively as part of the global Etex Group.

Recent updates to Approved Document B emphasise a requirement to use European classifications and fire resistance technologies in accordance with EN 1363-1 and EN 1364-1. All systems shown have been tested to EN 1364-1 directly or extended using Direct Field of Application (DIAP) rules included in EN 1364-1 or extended using the Extended Field of Application (EXAP) standard EN 15254-3. All systems have been classified to EN 13501-2.

## Acoustic performance in internal partition wall systems - Schools and Hospitals.

**System Name:**  
**Twin(AB)-CS50R-15Un15dB-50G(200)**

**System Type: Partition**

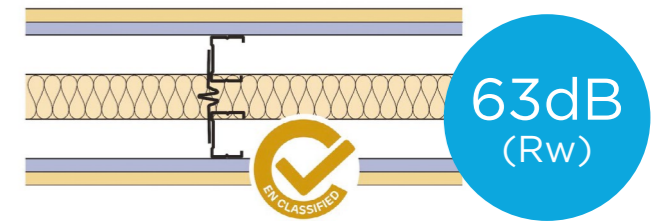

System Components				Performance		
Boarding on each side		Frame Type	Insulation	Acoustic Rw +Ctr (dB)	EN Fire State Max Height (metres)	Fire Resistance to EN 1364-1 (minutes)
Inner	Outer					
1 x 15mm Siniat dB Board	1 x 15mm Siniat Universal Board	Twin Siniat CS50/Rx C-Studs at 600mm centres with Acoustic V Brace	50mm Superglass Acoustic Partition Roll (APR)	63-8	5	EI 120

**System Name:**  
**CS70R-15Un12Ply-25G**

**System Type: Partition**

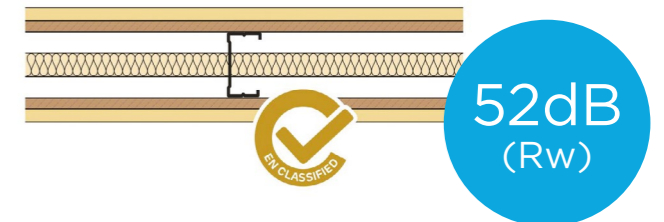

System Components				Performance		
Boarding on each side		Frame Type	Insulation	Acoustic Rw +Ctr (dB)	EN Fire State Max Height (metres)	Fire Resistance to EN 1364-1 (minutes)
Inner	Outer					
1 x 12mm Plywood	1 x 15mm Siniat Universal Board	Siniat CS70/Rx C-Stud at 600mm centres	25mm Superglass Acoustic Partition Roll (APR)	52	3.75	EI 60

**System Name:**  
**CS70R-15Un-50G**

**System Type: Partition**

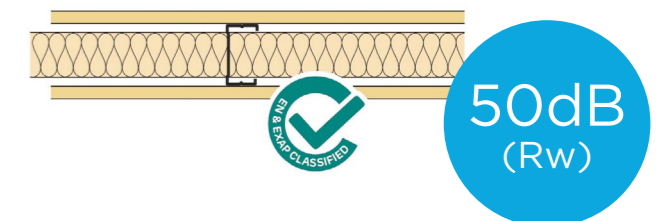

System Components			Performance		
Boarding on each side	Frame Type	Insulation	Acoustic Rw +Ctr (dB)	EN Fire State Max Height (metres)	Fire Resistance to EN 1364-1 (minutes)
1 x 15mm Siniat Universal Board	Siniat CS70/Rx C-Stud at 600mm centres	50mm Superglass Acoustic Partition Roll (APR)	50	3.75	EI 60

For further information relating to any of the Siniat products shown please contact [technical@siniat.co.uk](mailto:technical@siniat.co.uk) or visit [www.siniat.co.uk/en-gb/](http://www.siniat.co.uk/en-gb/)

# Acoustic performance in internal partition wall systems - Schools and Hospitals.

**System Name:**  
CS90R-15Un12Ply-25G

**System Type:** Partition

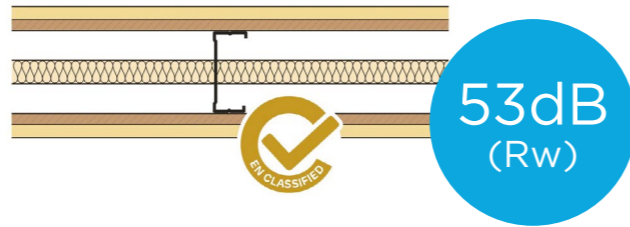

System Components				Performance		
Boarding on each side		Frame Type	Insulation	Acoustic Rw +Ctr (dB)	EN Fire State Max Height (metres)	Fire Resistance to EN 1364-1 (minutes)
Inner	Outer					
1 x 12mm Plywood	1 x 15mm Siniat Universal Board	Siniat CS90/Rx C-Stud at 600mm centres	25mm Superglass Acoustic Partition Roll (APR)	53	4.65	EI 60

**System Name:**  
CS70R-15Un-25G

**System Type:** Partition

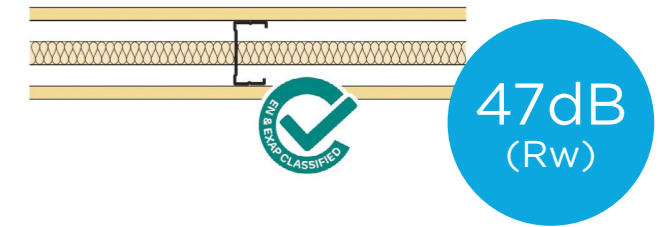

System Components			Performance		
Boarding on each side	Frame Type	Insulation	Acoustic Rw +Ctr (dB)	EN Fire State Max Height (metres)	Fire Resistance to EN 1364-1 (minutes)
1 x 15mm Siniat Universal Board	Siniat CS70/Rx C-Stud at 600mm centres	25mm Superglass Acoustic Partition Roll (APR)	47	3.75	EI 60

**System Name:**  
CS70R-212dB-25G

**System Type:** Partition

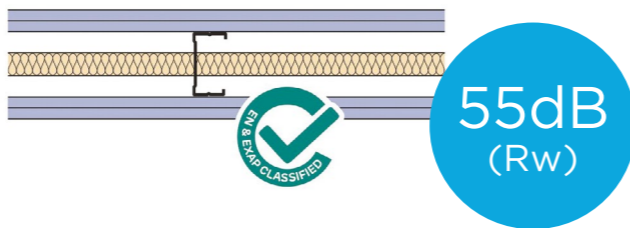

System Components				Performance		
Boarding on each side		Frame Type	Insulation	Acoustic Rw +Ctr (dB)	EN Fire State Max Height (metres)	Fire Resistance to EN 1364-1 (minutes)
Inner	Outer					
1 x 12.5mm Siniat dB Boards	1 x 12.5mm Siniat dB Boards	Siniat CS70/Rx C-Stud at 600mm centres	25mm Superglass Acoustic Partition Roll (APR)	55	4.6	EI 60

**System Name:**  
CS70R-215dB-25G

**System Type:** Partition

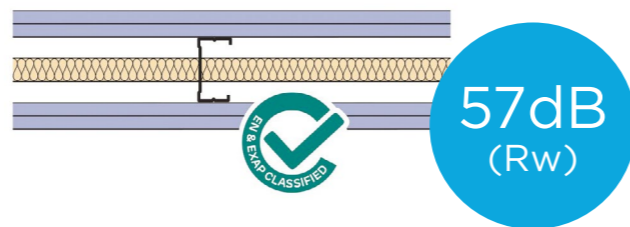

System Components				Performance		
Boarding on each side		Frame Type	Insulation	Acoustic Rw +Ctr (dB)	EN Fire State Max Height (metres)	Fire Resistance to EN 1364-1 (minutes)
Inner	Outer					
1 x 15mm Siniat dB Boards	1 x 15mm Siniat dB Boards	Siniat CS70/Rx C-Stud at 600mm centres	25mm Superglass Acoustic Partition Roll (APR)	57	5	EI 90



For further information relating to any of the Siniat products shown please contact [technical@siniat.co.uk](mailto:technical@siniat.co.uk) or visit [www.siniat.co.uk/en-gb/](http://www.siniat.co.uk/en-gb/)

# Acoustic performance in internal partition wall systems - Residential Buildings.

**System Name:**  
**Twin(AB)-CS50R-15Un15dB-100G(250)**

**System Type: Partition**

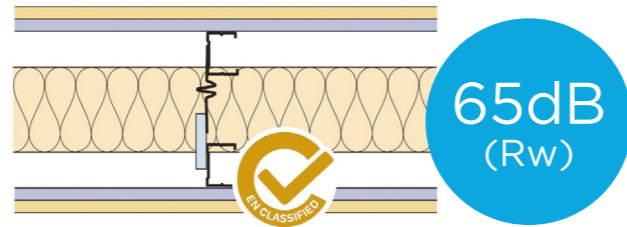

System Components				Performance		
Boarding on each side		Frame Type	Insulation	Acoustic Rw +Ctr (dB)	EN Fire State Max Height (metres)	Fire Resistance to EN 1364-1 (minutes)
Inner	Outer					
1 x 15mm Siniat dB Board	1 x 15mm Siniat Universal Board	Twin Siniat CS50/Rx C-Studs at 600mm centres with Siniat Acoustic V Brace and suitable stud or channel	100mm Superglass Multi Acoustic Roll	64 -6	5	EI 120

**System Name:**  
**Twin(AB)-CS50R-215dB-50G(250)**

**System Type: Partition**

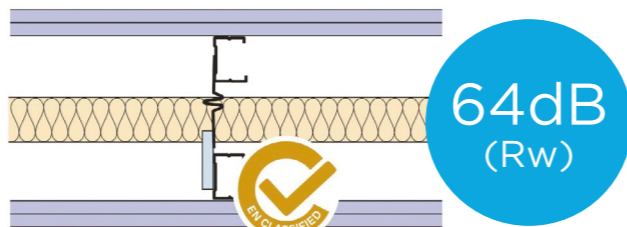

System Components				Performance		
Boarding on each side		Frame Type	Insulation	Acoustic Rw +Ctr (dB)	EN Fire State Max Height (metres)	Fire Resistance to EN 1364-1 (minutes)
Inner	Outer					
1 x 15mm Siniat dB Boards	1 x 15mm Siniat dB Boards	Twin Siniat CS50/Rx C-Studs at 600mm centres with Siniat Acoustic V Brace and suitable stud or channel	50mm Superglass Acoustic Partition Roll (APR)	64 -6	5	EI 90

**System Name:**  
**CS70R-212F-25G**

**System Type: Partition**

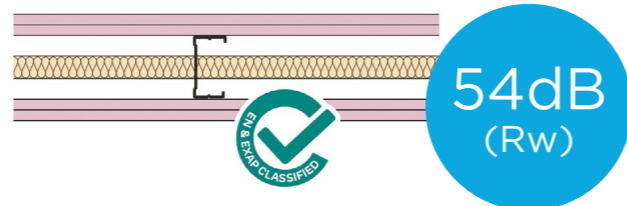

System Components				Performance		
Boarding on each side		Frame Type	Insulation	Acoustic Rw +Ctr (dB)	EN Fire State Max Height (metres)	Fire Resistance to EN 1364-1 (minutes)
Inner	Outer					
1 x 12.5mm Siniat Fire Boards	1 x 12.5mm Siniat Fire Boards	Siniat CS70/Rx C-Stud at 600mm centres	25mm Superglass Acoustic Partition Roll (APR)	54	4	EI 120

For further information relating to any of the Siniat products shown please contact [technical@siniat.co.uk](mailto:technical@siniat.co.uk) or visit [www.siniat.co.uk/en-gb/](http://www.siniat.co.uk/en-gb/)

**System Name:**  
**CS70R-12dB-25G**

**System Type: Partition**

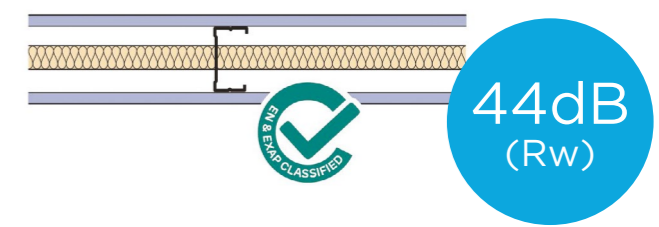

System Components			Performance		
Boarding on each side	Frame Type	Insulation	Acoustic Rw +Ctr (dB)	EN Fire State Max Height (metres)	Fire Resistance to EN 1364-1 (minutes)
1 x 12.5mm Siniat dB Board	Siniat CS70/Rx C-Stud at 600mm centres	25mm Superglass Acoustic Partition Roll (APR)	44	3.5	EI 30

**System Name:**  
**CS50R-15dB-25G**

**System Type: Partition**

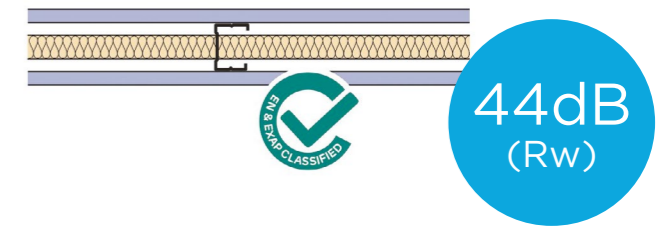

System Components			Performance		
Boarding on each side	Frame Type	Insulation	Acoustic Rw +Ctr (dB)	EN Fire State Max Height (metres)	Fire Resistance (EN 1364-1) (minutes)
1 x 15mm Siniat dB Board	Siniat CS50/Rx C-Stud at 600mm centres	25mm Superglass Acoustic Partition Roll (APR)	44	3	EI 30

**System Name:**  
**CS70R-15St-25G**

**System Type: Partition**

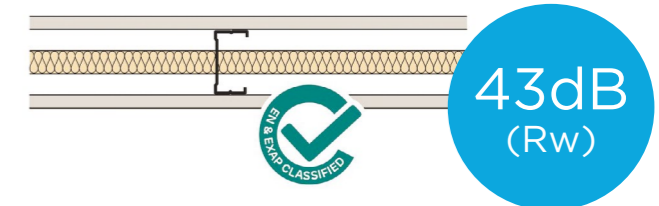

System Components			Performance		
Boarding on each side	Frame Type	Insulation	Acoustic Rw +Ctr (dB)	EN Fire State Max Height (metres)	Fire Resistance to EN 1364-1 (minutes)
1 x 15mm Siniat Standard Board	Siniat CS70/Rx C-Stud at 600mm centres	25mm Superglass Acoustic Partition Roll (APR)	43	3.4	EI 30

For further information relating to any of the Siniat products shown please contact [technical@siniat.co.uk](mailto:technical@siniat.co.uk) or visit [www.siniat.co.uk/en-gb/](http://www.siniat.co.uk/en-gb/)

# Acoustic performance in internal partition wall systems - Residential Buildings.

**System Name:**  
**CS50R-15St-25G**

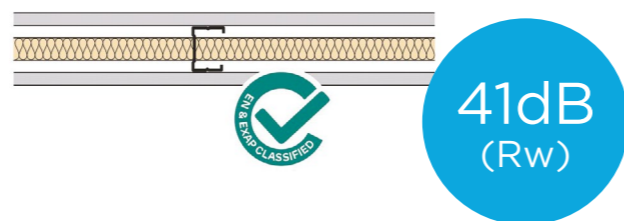

**System Type: Partition**

System Components			Performance		
Boarding on each side	Frame Type	Insulation	Acoustic Rw +Ctr (dB)	EN Fire State Max Height (metres)	Fire Resistance to EN 1364-1 (minutes)
1 x 15mm Siniat Standard Board	Siniat CS50/Rx C-Stud at 600mm centres	25mm Superglass Acoustic Partition Roll (APR)	41	4.8	EI 30

**System Name:**  
**IS60B(400)-212dB#0-25G**

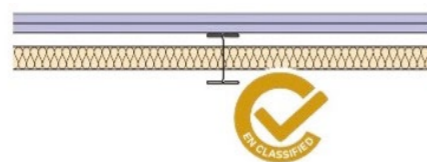

**System Type: Independent Wall Lining**

System Components			Performance		
Boarding	Frame Type	Insulation	Fire Resistance to EN 1364-1 (minutes)	EN Fire State Max Height (metres)	Direction of fire exposure
2 x 12.5mm Siniat dB Board (to one side only)	Siniat IS60/B I-Studs at 400mm centres	25mm Superglass Acoustic Partition Roll (APR)	EI 30	4.1	From boarded direction only

**System Name:**  
**CH60B-19FC#315F-25G**

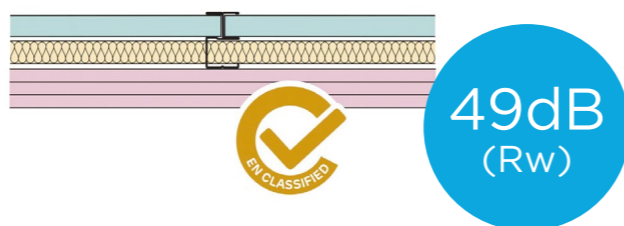

**System Type: Shaftwall**

System Components			Performance			
Boarding on each side		Frame Type	Insulation	Acoustic Rw +Ctr (dB)	EN Fire State Max Height (metres)	Fire Resistance to EN 1364-1 (minutes)
Inner	Outer					
1 x 19 mm Siniat Fire Core Board	3 x 15 mm Siniat Fire Board	Siniat CHS60/B CH-Studs at 600mm centres	25mm Superglass Acoustic Partition Roll (APR)	49	4.8	EI 120

For further information relating to any of the Siniat products shown please contact [technical@siniat.co.uk](mailto:technical@siniat.co.uk) or visit [www.siniat.co.uk/en-gb/](http://www.siniat.co.uk/en-gb/)



Intelligent environments  
**Superglass**  
by etex

Etex UK Insulation Limited | Thistle Industrial Estate | Kerse Road | Stirling | FK7 7QQ | UK

IPS03  
December 2025

**Technical**

Hotline: 0808 1645 134  
Email: [technical.stirling@etexgroup.com](mailto:technical.stirling@etexgroup.com)

**Customer Services**

Tel: 01786 451170  
Email: [customerservice.stirling@etexgroup.com](mailto:customerservice.stirling@etexgroup.com)

**Social**

[superglass\\_uk](#)
[superglassuk/](#)
[superglassinsulationuk](#)

REF: 50483

All rights are reserved, including those of photomechanical reproduction and storage in electronic media. Commercial use of the processes and work activities presented in this document is not permitted. Extreme caution was observed when putting together the information, texts, and illustrations in this document. Nevertheless, errors cannot quite be ruled out. The publisher and editors cannot assume legal responsibility or any liability whatever for incorrect information and the consequences thereof. The publisher and editors will be grateful for improvement suggestions and details of errors pointed out. Please check this is the current version by visiting the Superglass website. For archived versions please contact the Technical Services Team.