

URSA HOMETEC ROLL 35

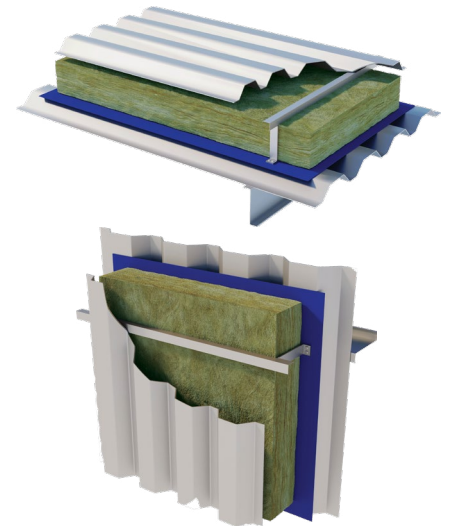

Typical applications:

Twin skin profiled metal clad systems.



Description.

URSA HOMETEC ROLL 35 is a non-combustible glass mineral wool insulation roll. The roll is supplied 1200mm wide.



Non-combustible



Thermal Insulation



Recycled Glass Content

Application.

URSA HOMETEC ROLL 35 is designed to provide thermal and acoustic insulation in the walls and roofs of twin skin profiled metal clad systems and portable & modular buildings.

The product can also be used as thermal and acoustic insulation various applications, including timber frame walls, roofs, and floors.

Performance.

Thermal Conductivity:

Declared thermal conductivity (lambda (λ) value) of 0.035 W/mK.

Density:

Manufactured at a nominal density of 22 kg/m³.

Fire Classification:

Deemed non-combustible with a fire classification of Euroclass A1 (the highest possible rating) when tested to EN 13501-1:2018 Reaction to Fire.



Technical Characteristics.

Product Specification.

Thickness (mm)	Length (mm)	Width (mm)	Pack Area (m ²)	Packs per pallet	Pallet Area (m ²)	Thermal Conductivity (W/mK)	Thermal Resistance (m ² K/W)	Product Code
60	11000	1200	13.20	18	237.60	0.035	1.70	2141951
80	8000	1200	9.60	18	172.80	0.035	2.25	2075264
100	6500	1200	7.80	18	140.40	0.035	2.85	2141953
120	6000	1200	7.20	18	129.60	0.035	3.40	2144458
140	5000	1200	6.00	18	108.00	0.035	4.00	2144459
150	4000	1200	4.80	18	86.40	0.035	4.25	2075262
160	4500	1200	5.40	18	97.20	0.035	4.55	2144460
180	4000	1200	4.80	18	86.40	0.035	5.10	2144491
200	3600	1200	4.32	18	77.76	0.035	5.70	2144492
220	3200	1200	3.84	18	69.12	0.035	6.25	2144493
240	3000	1200	3.60	18	64.80	0.035	6.85	2144494
260	2700	1200	3.24	18	58.32	0.035	7.40	2144495

Please note that all dimensions are nominal.

Additional Information.

CCPI (Code for Construction Products Information).

Holds CCPI Assessment Mark.
Certificate number: 005800185/1027.

Vapour Resistivity.

The product has a nominal vapour resistivity of 5 MNs/gm.

Environmental Credentials.

- The primary packaging on our products (rolls and slabs) and pallets (the shrink hood) are wrapped in low-density polyethylene (LDPE4) plastic, which contains a minimum 30% recycled material and is fully recyclable. The secondary packaging on our products (grouping rolls and slabs into modules of 3-6 packs) is low-density polyethylene (LDPE4) virgin plastic. Before recycling, please consult your local authority for guidance.
- ISO 14001:2015+A1:2024 - Environmental Management Systems (EMS) certified. Certificate number: BQA_EMS_C_2016673.
- Contains no ozone-depleting substances or greenhouse gases.
- Manufactured from up to 73% recycled glass.
- Environmental Product Declarations (EPDs) for our products, detailing their overall environmental performance, are published and accessible on our website.

Standards and Approvals.

Manufactured in accordance with:

- EN 13162:2012+A1:2015 Thermal insulation products for buildings - Factory made mineral wool (MW) products.
- EN 13172: 2012 Thermal insulation products - Evaluation of conformity.
- ISO 9001:2015 - Quality Management Systems (QMS). Certificate number: 01 100 1300949.

Certification.

- CE marked to EN 13162:2012+A1:2015. Certificate number: 1163-CPR-0051.

EUCEB (European Certification Board of Mineral Wool Products).

All URSA glass mineral wool products are made of non-classified fibres and are certified by EUCEB. EUCEB is a voluntary initiative by the mineral wool industry. It is an independent certification authority that guarantees that products are made of fibres which comply with the exoneration criteria for carcinogenicity (Note Q) of the Regulation (EC) 1272/2008. Certificate number: BEUC-511-46-376-46.

Handling & Storage.

The product must be stored and handled in a manner that ensures it remains clean and undamaged. It is supplied compression-packed in polythene, which provides short-term protection only. For long-term protection, store the product indoors or under a waterproof covering, raised off the ground, to prevent weather-related damage.

During construction, all exposed areas of the product must be covered at the end of each working day and during adverse weather conditions, including rain, wind, or snow. Use polythene sheeting or an equivalent protective cover to prevent water saturation. The product must not be left permanently exposed to the elements.

All URSA products are non-hygroscopic, will not rot, degrade, or sustain vermin and will not encourage the growth of mould, bacteria, or fungi.

URSA TERRA.

Developed in 2009, URSA TERRA showcases the latest in glass mineral wool technology. Our distinctive production methods and product formulation define the character of our extensive insulation product range.



Etex UK Insulation Limited. Thistle Industrial Estate, Kerse Road, Stirling, Scotland FK7 7QQ ursa-uk.co.uk

Technical: T. 0808 1645 134 | E. technicalursa.uk@etexgroup.com | Customer Services: T. 01786 451170 | E. customerservice.stirling@etexgroup.com