

# URSA HOMETEC ROLL 35

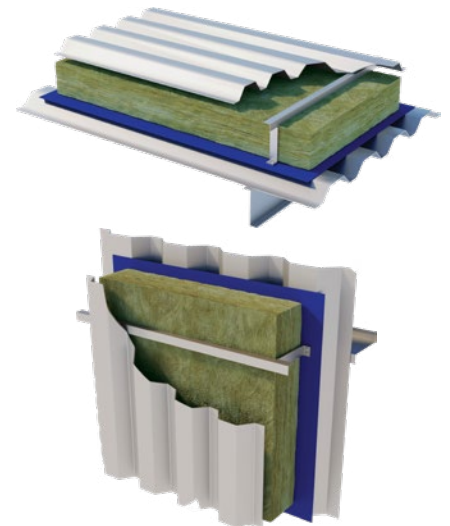

## Typical applications:

Twin skin profiled metal clad systems.



## Description.

URSA HOMETEC ROLL 35 is a non-combustible glass mineral wool insulation roll. The roll is supplied 1200mm wide.

## Application.

URSA HOMETEC ROLL 35 is designed to provide thermal and acoustic insulation in the walls and roofs of twin skin profiled metal clad systems and portable & modular buildings.

The product can also be used as thermal and acoustic insulation various applications, including timber frame walls, roofs, and floors.

## Performance.

### Thermal Conductivity:

Declared thermal conductivity ( $\lambda$ ) value of 0.035 W/mK.

### Density:

Manufactured at a nominal density of 22 kg/m<sup>3</sup>.

### Fire Classification:

Deemed non-combustible with a fire classification of Euroclass A1 (the highest possible rating) when tested to EN 13501-1:2018 Reaction to Fire.



Non-combustible



Thermal Insulation



Recycled Glass Content

# Technical Characteristics.

## Product Specification.

Thickness (mm)	Length (mm)	Width (mm)	Pack Area (m²)	Packs per pallet	Pallet Area (m²)	Thermal Conductivity (W/mK)	Thermal Resistance (m²K/W)	Product Code
60	11000	1200	13.20	18	237.60	0.035	1.70	2141951
80	8000	1200	9.60	18	172.80	0.035	2.25	2075264
100	6500	1200	7.80	18	140.40	0.035	2.85	2141953
120	6000	1200	7.20	18	129.60	0.035	3.40	2144458
140	5000	1200	6.00	18	108.00	0.035	4.00	2144459
150	4000	1200	4.80	18	86.40	0.035	4.25	2075262
160	4500	1200	5.40	18	97.20	0.035	4.55	2144460
180	4000	1200	4.80	18	86.40	0.035	5.10	2144491
200	3600	1200	4.32	18	77.76	0.035	5.70	2144492
220	3200	1200	3.84	18	69.12	0.035	6.25	2144493
240	3000	1200	3.60	18	64.80	0.035	6.85	2144494
260	2700	1200	3.24	18	58.32	0.035	7.40	2144495

Please note that all dimensions are nominal.

## Additional Information.

### Vapour Resistivity.

The product has a nominal vapour resistivity of 5 MNs/gm.

### Environmental Credentials.

- The primary packaging on our products (rolls and slabs) and pallets (the shrink hood) are wrapped in low-density polyethylene (LDPE4) plastic, which contains a minimum 30% recycled material and is fully recyclable. The secondary packaging on our products (grouping rolls and slabs into modules of 3-6 packs) is low-density polyethylene (LDPE4) virgin plastic. Before recycling, please consult your local authority for guidance.
- ISO 14001:2015 – Environmental Management Systems (EMS) certified. Certificate number: BQA\_EMS\_C\_2016673.
- Contains no ozone-depleting substances or greenhouse gases.
- Manufactured from up to 73% recycled glass.
- Generic BRE Green Guide Rating of A+.

### Standards and Approvals.

Manufactured in accordance with:

- EN 13162:2012+A1:2015 Thermal insulation products for buildings – Factory made mineral wool (MW) products.
- EN 13172: 2012 Thermal insulation products – Evaluation of conformity.
- ISO 9001:2015 – Quality Management Systems (QMS). Certificate number: 01 100 1300949.

### Certification.

- CE marked to EN 13162:2012+A1:2015. Certificate number: 1163-CPR-0051.

### EUCEB (European Certification Board of Mineral Wool Products).

All URSA glass mineral wool products are made of non-classified fibres and are certified by EUCEB. EUCEB is a voluntary initiative by the mineral wool industry. It is an independent certification authority that guarantees that products are made of fibres which comply with the exoneration criteria for carcinogenicity (Note Q) of the Regulation (EC) 1272/2008. Certificate number: BEUC-511-46-376-46.

### Handling & Storage.

The product should be stored properly and handled in such a way as to ensure that the product remains clean and undamaged.

The product is supplied compression packed in polythene to provide short term protection only. For long term protection, the product must be stored indoors, or under a waterproof covering and off the ground to protect from weather damage. The product should not be left permanently exposed to the elements.

All URSA products are non-hygroscopic, will not rot, degrade, or sustain vermin and will not encourage the growth of mould, bacteria, or fungi.

### URSA TERRA.

Developed in 2009, URSA TERRA showcases the latest in glass mineral wool technology. Our distinctive production methods and product formulation define the character of our extensive insulation product range.



Etex UK Insulation Limited. Thistle Industrial Estate, Kerse Road, Stirling, Scotland FK7 7QQ [ursa-uk.co.uk](http://ursa-uk.co.uk)

Technical: T. 0808 1645 134 | E. [technicalursa.uk@etexgroup.com](mailto:technicalursa.uk@etexgroup.com) | Customer Services: T. 01786 451170 | E. [customerservice.stirling@etexgroup.com](mailto:customerservice.stirling@etexgroup.com)

All rights are reserved, including those of photomechanical reproduction and storage in electronic media. Commercial use of the processes and work activities presented in this document is not permitted. Extreme caution was observed when putting together the information, texts, and illustrations in this document. Nevertheless, errors cannot quite be ruled out. The publisher and editors cannot assume legal responsibility or any liability whatever for incorrect information and the consequences thereof. The publisher and editors will be grateful for improvement suggestions and details of errors pointed out. Please check this is the current version by visiting the URSA website. For archived versions please contact the Technical Services Team.

USHT3502  
July 2025