

LISTE OVER TEGNINGER

Beskrivelse		Dato		
Cedral Lap - Vandret montering Detaljer		2022-02-07		
		Sidste rev. dato 2023-01-24		
Tegningsnummer	Beskrivelse	Skala	Dato	Rev. dato
CL00	Placering afstandliste gavl / væg	-	20220116	20220603
CL01	Profiler Cedral Lap – Vandret montering	1:2	20220116	
CL02	Startprofil vandret montering Jordniveau	1:2	20220116	
CL03	Sålbænk detalje	1:2	20220116	
CL04	Vandnæse vindue - startprofil	1:2	20220116	
CL04A	Vandnæse vindue - alternativ	1:2	20220116	
CL04B	Vandnæse vindue - alternativ	1:2	20220116	20230124
CL05	Top facade mod beton/sten	1:2	20220116	
CL05A	Top facade mod underbeklædning	1:2	20220116	
CL06	Standard samlinger	1:2	20220116	20230124
CL07	Symetrisk udvendigt hjørne	1:2	20220116	20230124
CL08	Sideinddækning vindue	1:2	20220116	20230124
CL08A	Asymmetrisk utvendig hjørne - vindue	1:2	20220116	20230124
CL09	Invendigt hjørne	1:2	20220116	20230124
CL10	Dobbelt endekant profil	1:2	20220116	20230124
CL11	Stern	1:2	20220116	
CL12	Vindskede	1:2	20220116	
CL12A	Vindskede - alternativ	1:2	20220116	

For yderligere oplysninger, kontakt venligst :

Tel: +45 73 66 19 99 | E-mail: etexnordic-dk@etexgroup.com | www.cedral.world
Etex Nordic A/S | Vendersgade 74 | DK-7000 Fredericia



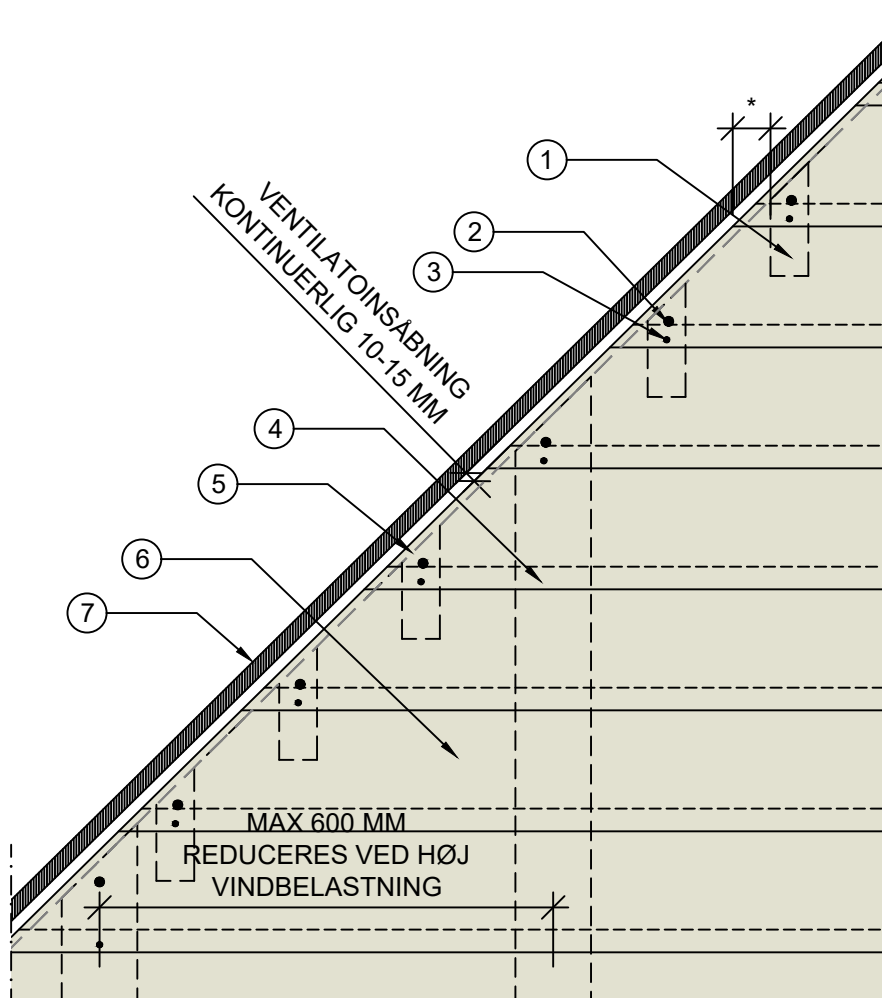

- ① AFSTANDSLISTE 25x50/25x100 L=150 MM * PLACERES 50 / 100 MM FRA ENDESPIDS
- ② SYNLIG I-FIX TRÆSKRUE 4,8x39 ANBEFALES VED VED TAGHÆLDNING UNDER 25 GRADER
- ③ SKJULT SQD SKRUE 4,2x45 [4034483]
- ④ AFSTANDSLISTE 25x100 MAX C/C 600 MM
- ⑤ PERFORERET VENTILATIONSPROFIL [4017076, 4017078]
- ⑥ CEDRAL LAP
- ⑦ UNDERBEKLÆDNING

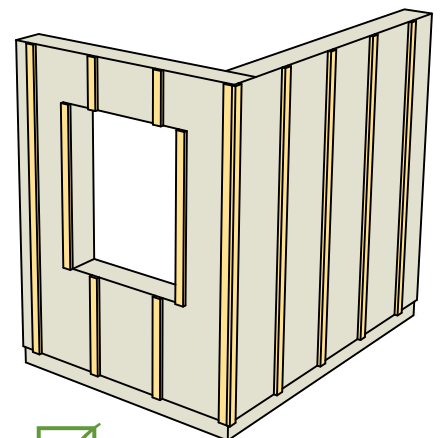
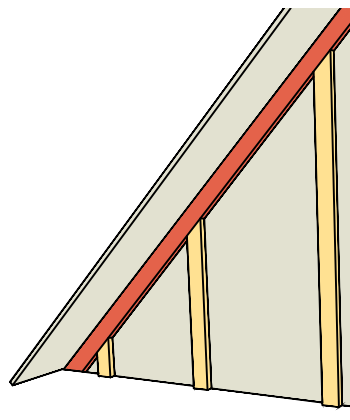
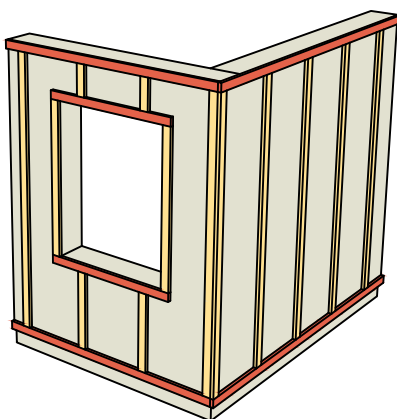
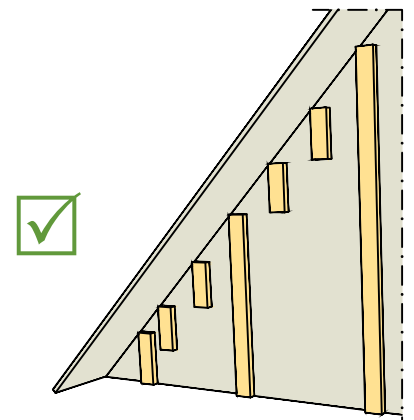

Copyright

This information is supplied in good faith but no liability can be accepted for any loss or damage resulting from use. All details and quantities must be checked and approved prior to order.

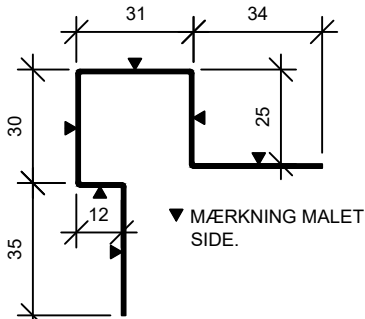

ASYMMETRISK
UDVENDIGT HJØRNE PROFIL

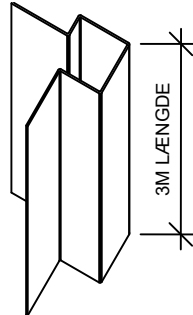

▼ MÆRKNING MALET
SIDE.

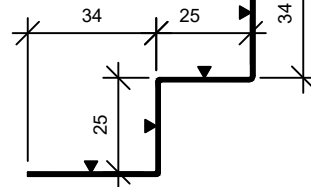

INDVENDIGT HJØRNE PROFIL

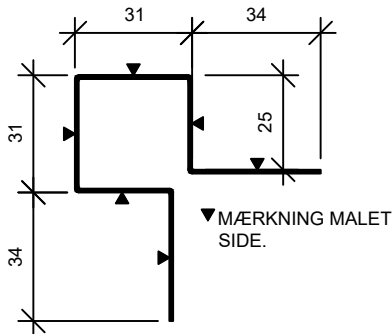
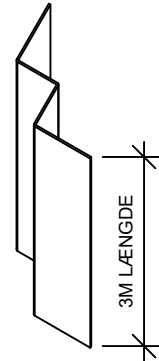

SYMMETRISK
UDVENDIGT HJØRNE PROFIL

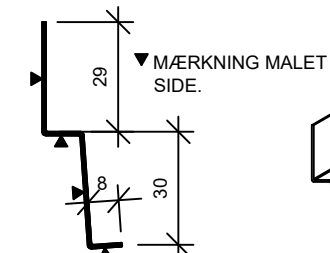
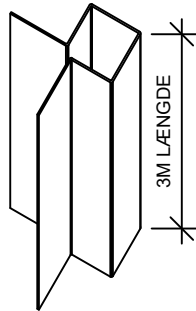

STARTPROFIL

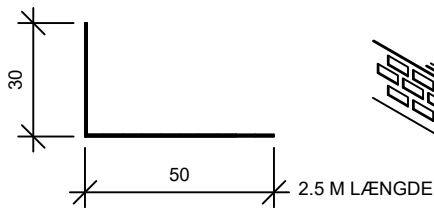
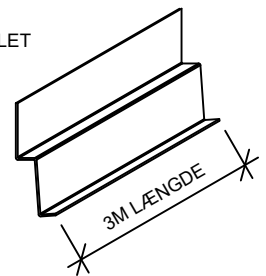

PERFORERET VENTILATIONSPROFIL [SOKKELSIKRING]
ART. NR. 4017078 - UBEHANDLET
ART. NR. 4017076 - SORT

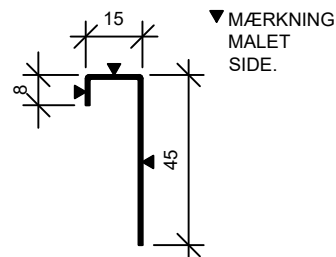

ENKEL ENDEKANT PROFIL

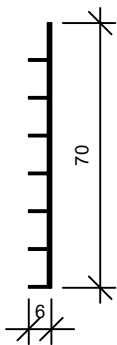
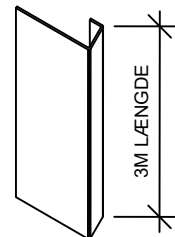

VENTILATIONSPROFIL PVC
ART. NR. 4009296

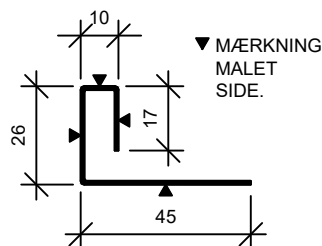
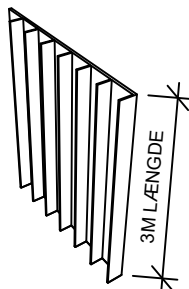

DOBBELT ENDEKANT PROFIL

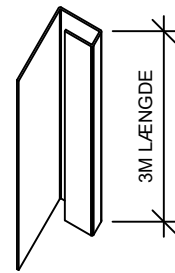

- ① SQD SKRUE 4,2x45 [4034483]
- ② CEDRAL LAP
- ③ AFSTANDSLISTE 25x100/25x50
- ④ MONTERINGSSKRUE ELLER SØM
- ⑤ STARTPROFIL
- ⑥ PERFORERT VENTILATIONSPROFIL [4017076, 4017078]

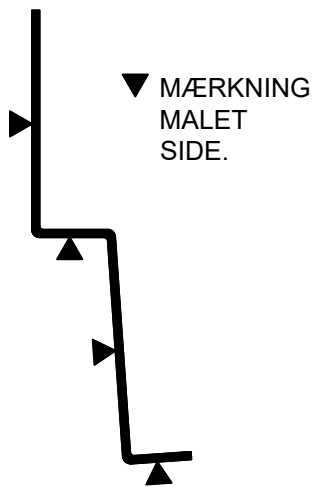

SEKTION STARTPROFIL 1:1

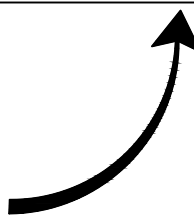
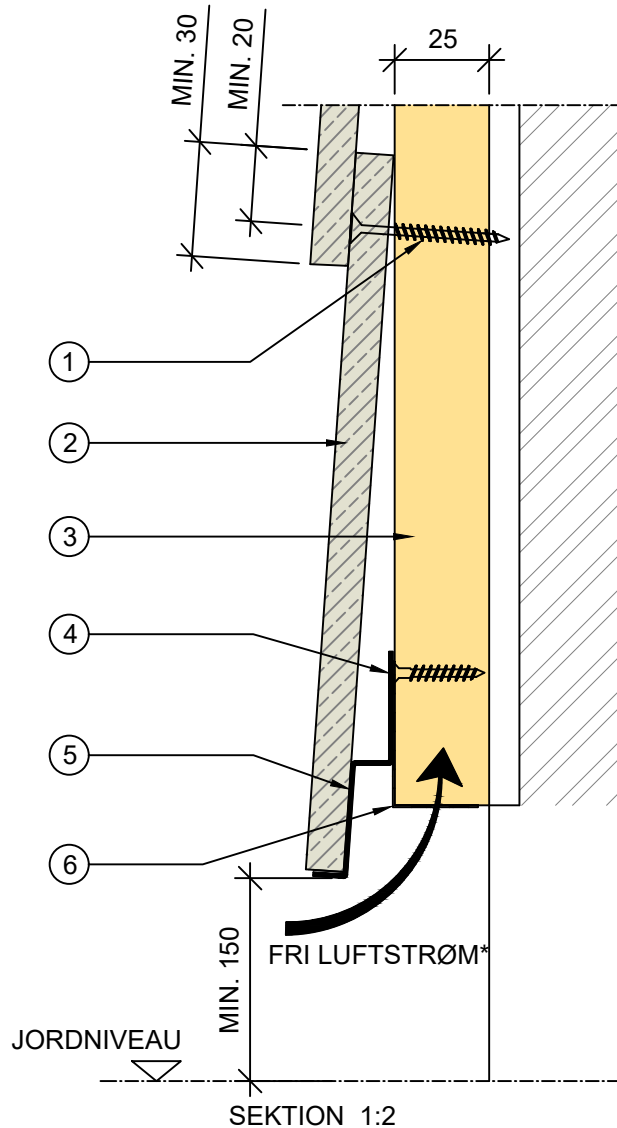
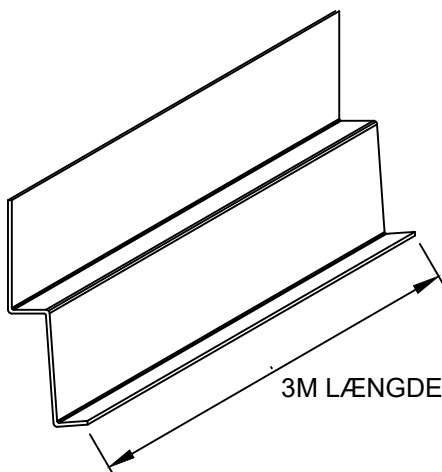

* FRI KONTINUERLIG LUFTSTRØM
 MINIMUM 100 CM²/M KONTINUERLIG ÅBNING VED
 INDLØBET/UDLØB - VED ANVENDELSE AF 25 MM
 KLEMLISTE OG SOKKELSIKRING GIVER DETTE EN FRI
 ÅBNING PÅ MINIMUM 100 CM²/M

FOR YDERLIGERE INFORMATION, VENLIGST KONTAKT:

INTERNET: WWW.CEDRAL.WORLD E-MAIL: etexnordic-dk@etexgroup.com TEL: +45 73 66 19 99
 ETEX NORDIC A/S, VENDERSGADE 74, DK-7000 FREDERICIA

- ① SÅLBÆNK
- ② PERFORERT VENTILATIONSPROFIL [4017076, 4017078]
- ③ SYNLIG I-FIX TRÆSKRUE 4,8x39
- ④ CEDRAL LAP
- ⑤ AFSTANDSLISTE 25x100/25x50
- ⑥ SQD SKRUE 4,2x45 [4034483]

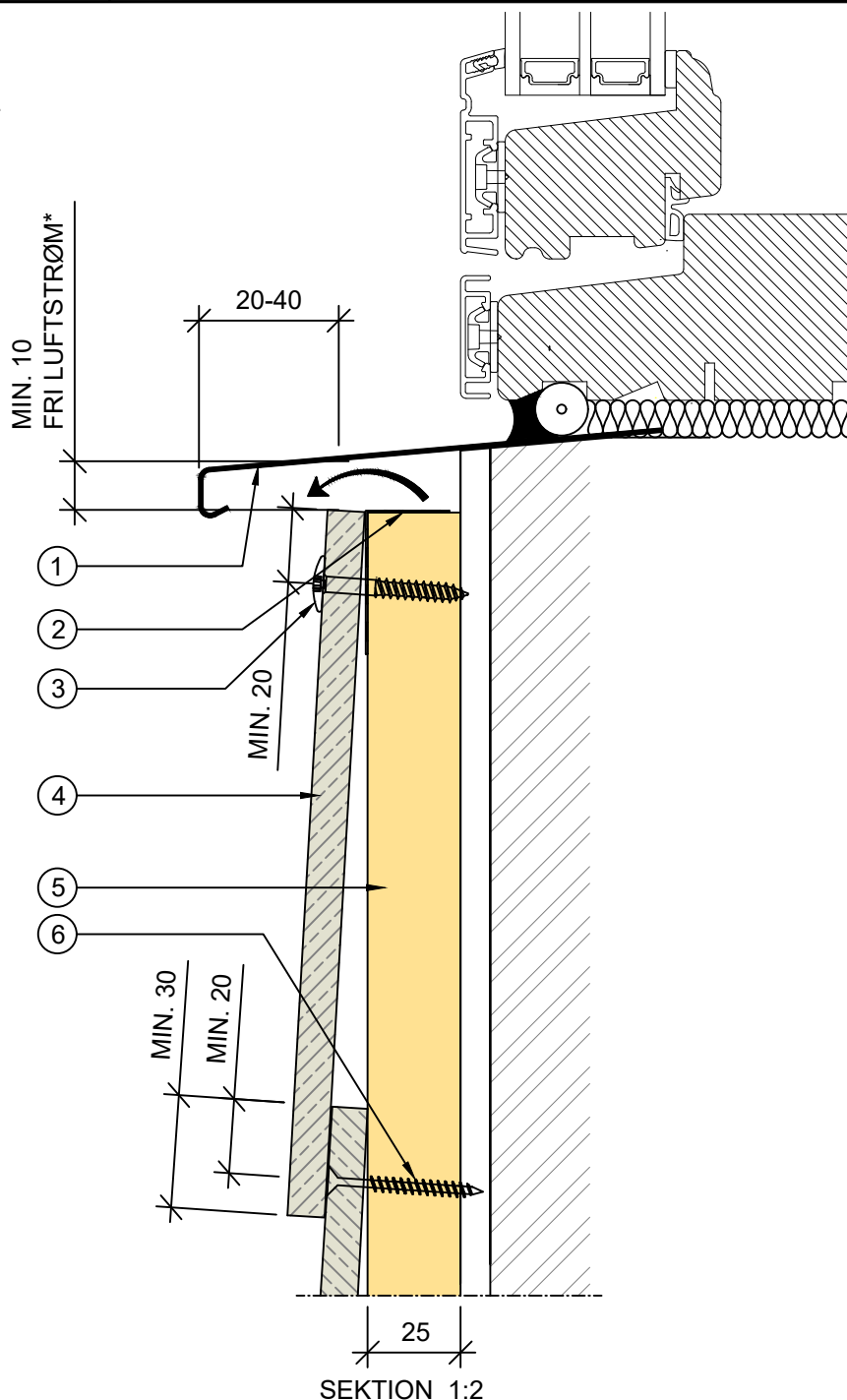

* FRI KONTINUERLIG LUFTSTRØM
 MINIMUM 100 CM²/M KONTINUERLIG ÅBNING VED
 INDLØBET/UDLØB - ANBEFALET FRI ÅBNING 10-15 MM

FOR YDERLIGERE INFORMATION, VENLIGST KONTAKT:

INTERNET: WWW.CEDRAL.WORLD E-MAIL: etexnordic-dk@etexgroup.com TEL: +45 73 66 19 99

ETEX NORDIC A/S, VENDERSGADE 74, DK-7000 FREDERICIA

- ① SQD SKRUE 4,2x45 [4034483]
- ② CEDRAL LAP
- ③ AFSTANDSLISTE 25x100/25x50
- ④ MONTERINGSSKRUE ELLER SØM
- ⑤ STARTPROFIL
- ⑥ PERFORERT VENTILATIONSPROFIL [4017076, 4017078]
- ⑦ VANDNÆSE CEDRAL LAP

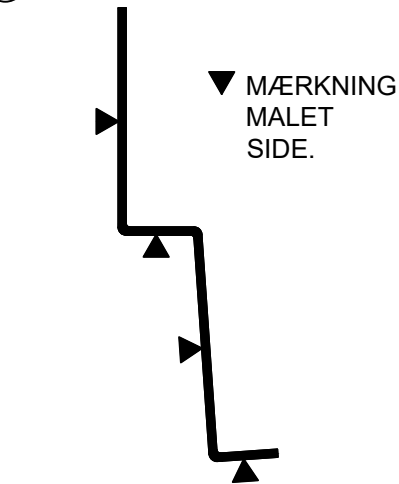

SEKTION STARTPROFIL 1:1

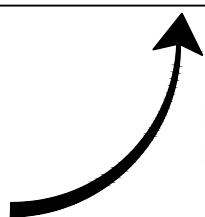
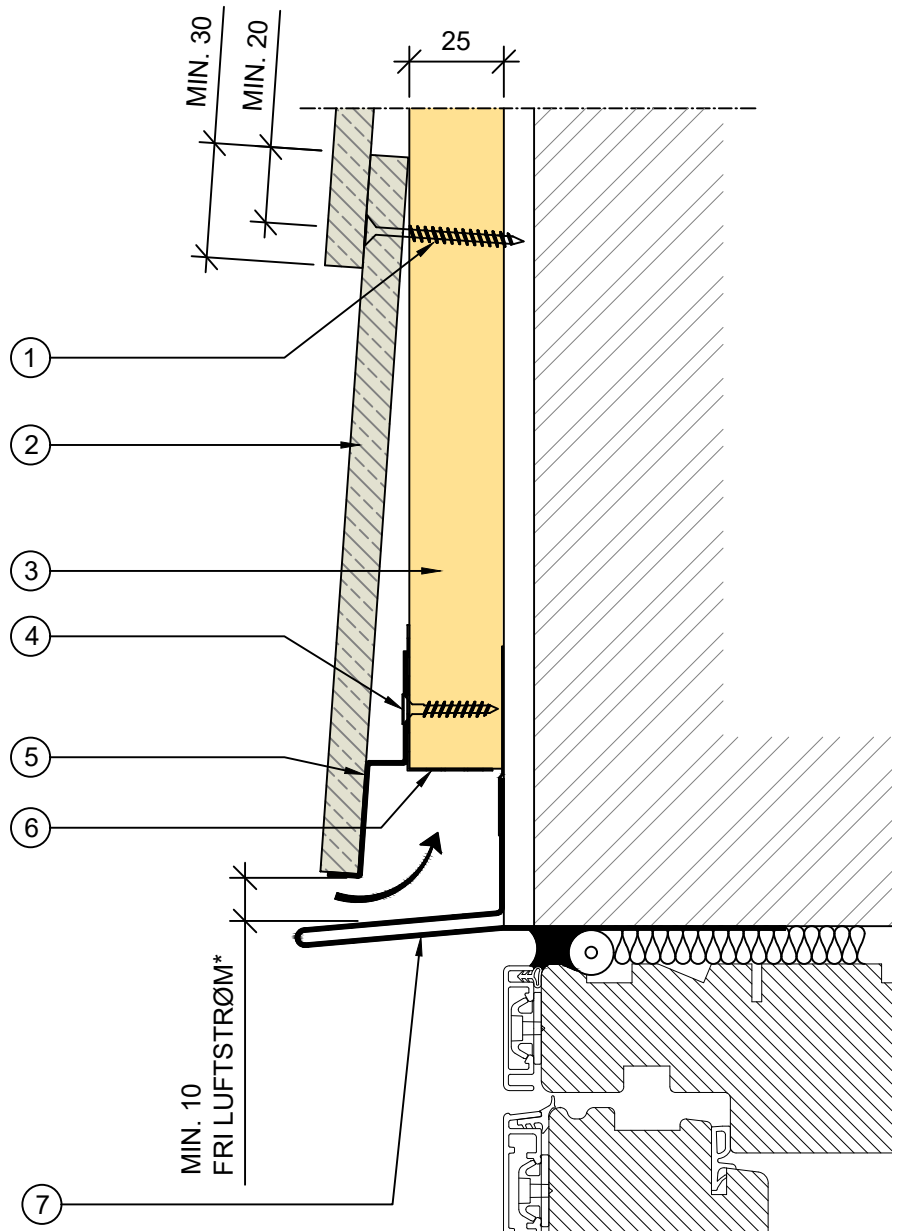
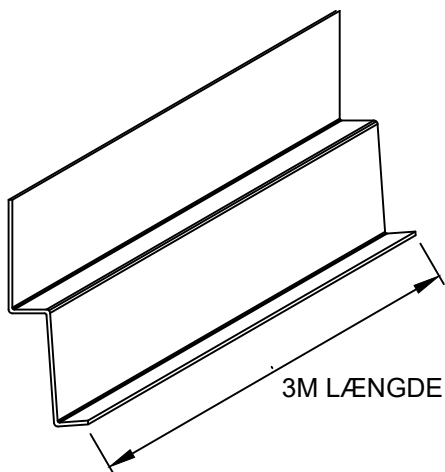

* FRI KONTINUERLIG LUFTSTRØM
MINIMUM 100 CM²/M KONTINUERLIG ÅBNING VED
INDLØBET/UDLØB - ANBEFALET FRI ÅBNING 10-15 MM

FOR YDERLIGERE INFORMATION, VENLIGST KONTAKT:

INTERNET: WWW.CEDRAL.WORLD E-MAIL: etexnordic-dk@etexgroup.com TEL: +45 73 66 19 99

ETEX NORDIC A/S, VENDERSGADE 74, DK-7000 FREDERICIA

- ① SQD SKRUE 4,2x45 [4034483]
- ② CEDRAL LAP
- ③ AFSTANDSLISTE 25x100/25x50
- ④ SYNLIG I-FIX TRÆSKRUE 4,8x39
- ⑤ TRÆ- ELLER PLASTIKKILE
[FORHANDLES IKKE AF ETEX]
- ⑥ PERFORERT VENTILATIONSPROFIL
[4017076, 4017078]
- ⑦ VANDNÆSE CEDRAL LAP

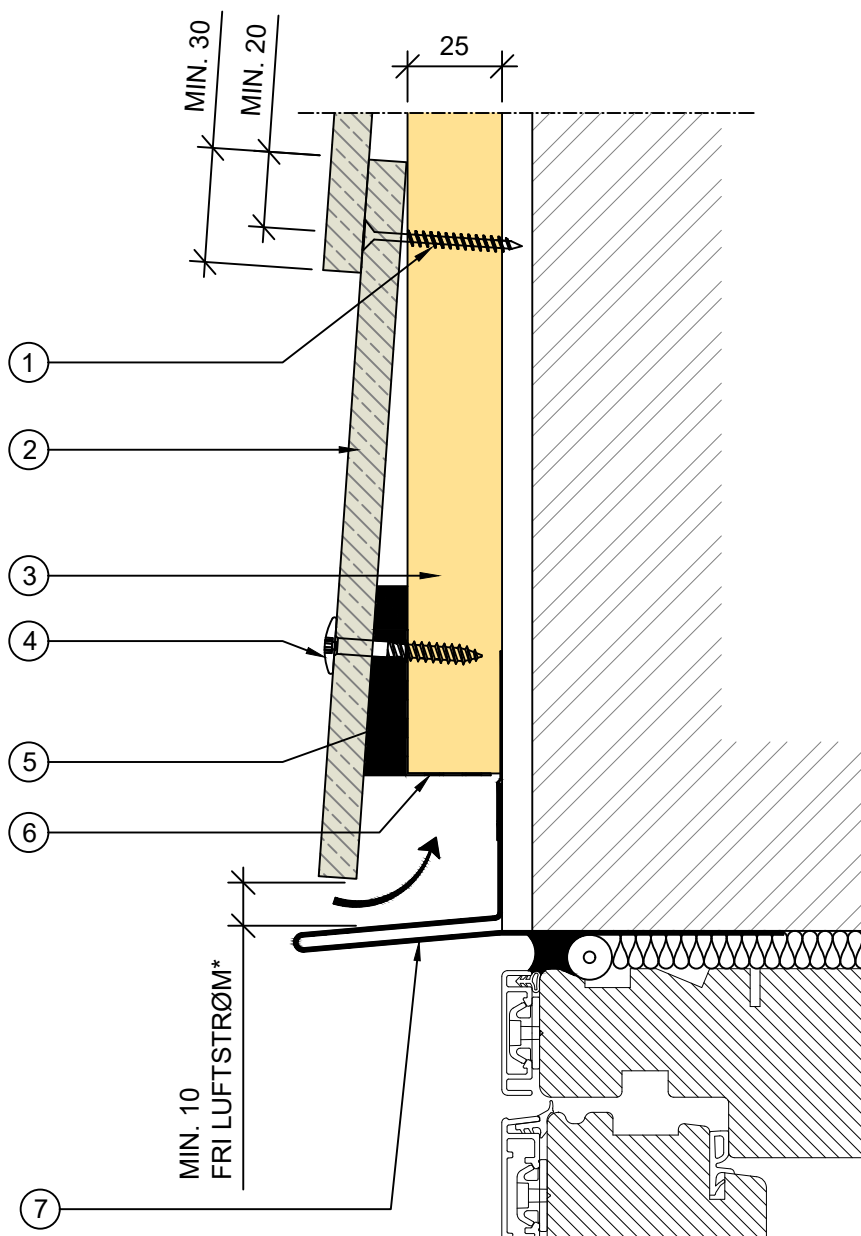

* FRI KONTINUERLIG LUFTSTRØM
MINIMUM 100 CM²/M KONTINUERLIG ÅBNING VED
INDLØBET/UDLØB - ANBEFALET FRI ÅBNING 10-15 MM

FOR YDERLIGERE INFORMATION, VENLIGST KONTAKT:

INTERNET: WWW.CEDRAL.WORLD E-MAIL: etexnordic-dk@etexgroup.com TEL: +45 73 66 19 99

ETEX NORDIC A/S, VENDERSGADE 74, DK-7000 FREDERICIA

- ① SQD SKRUE 4,2x45 [4034483]
- ② CEDRAL LAP
- ③ AFSTANDSLISTE 25x100/25x50
- ④ SYNLIG I-FIX TRÆSKRUE 4,8x39
- ⑤ TRÆ- ELLER PLASTIKKILE
- ⑥ PERFORERT VENTILATIONSPROFIL [4017076, 4017078]
- ⑦ EPDM BÅND [4087325]
- ⑧ CEDRAL LAP / CEDRAL BOARD
- ⑨ SYNLIG I-FIX TRÆSKRUE 4,8x39
- ⑩ SELVKLÆBENDE TÆTNINGSBÅND

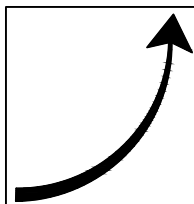
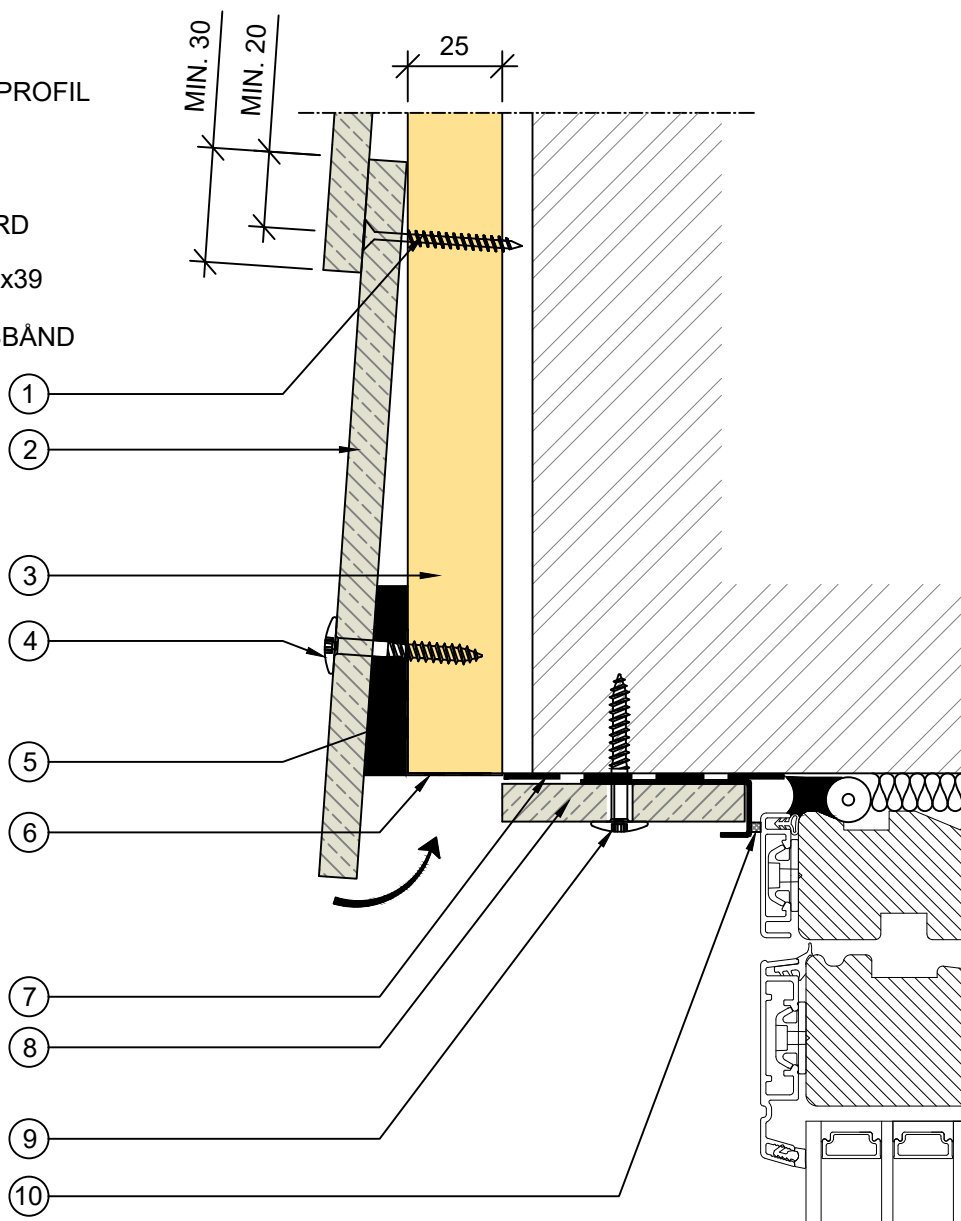

* FRI KONTINUERLIG LUFTSTRØM
 MINIMUM 100 CM²/M KONTINUERLIG ÅBNING VED
 INDLØBET/UDLØB - VED ANVENDELSE AF 25 MM
 KLEMLISTE OG PERFORERT VENTILATIONSPROFIL
 GIVER DETTE EN FRI ÅBNING PÅ MINIMUM 100 CM²/M

FOR YDERLIGERE INFORMATION, VENLIGST KONTAKT:

INTERNET: WWW.CEDRAL.WORLD E-MAIL: etexnordic-dk@etexgroup.com TEL: +45 73 66 19 99

ETEX NORDIC A/S, VENDERSGADE 74, DK-7000 FREDERICIA

Copyright

This information is supplied in good faith but no liability can be accepted for any loss or damage resulting from use. All details and quantities must be checked and approved prior to order.

- ① SQD SKRUE 4,2x45 [4034483]
- ② AFSTANDSLISTE 25x100/25x50
- ③ CEDRAL LAP
- ④ SYNLIG I-FIX TRÆSKRUE 4,8x39
- ⑤ PERFORERT VENTILATIONSPROFIL [4017076, 4017078]

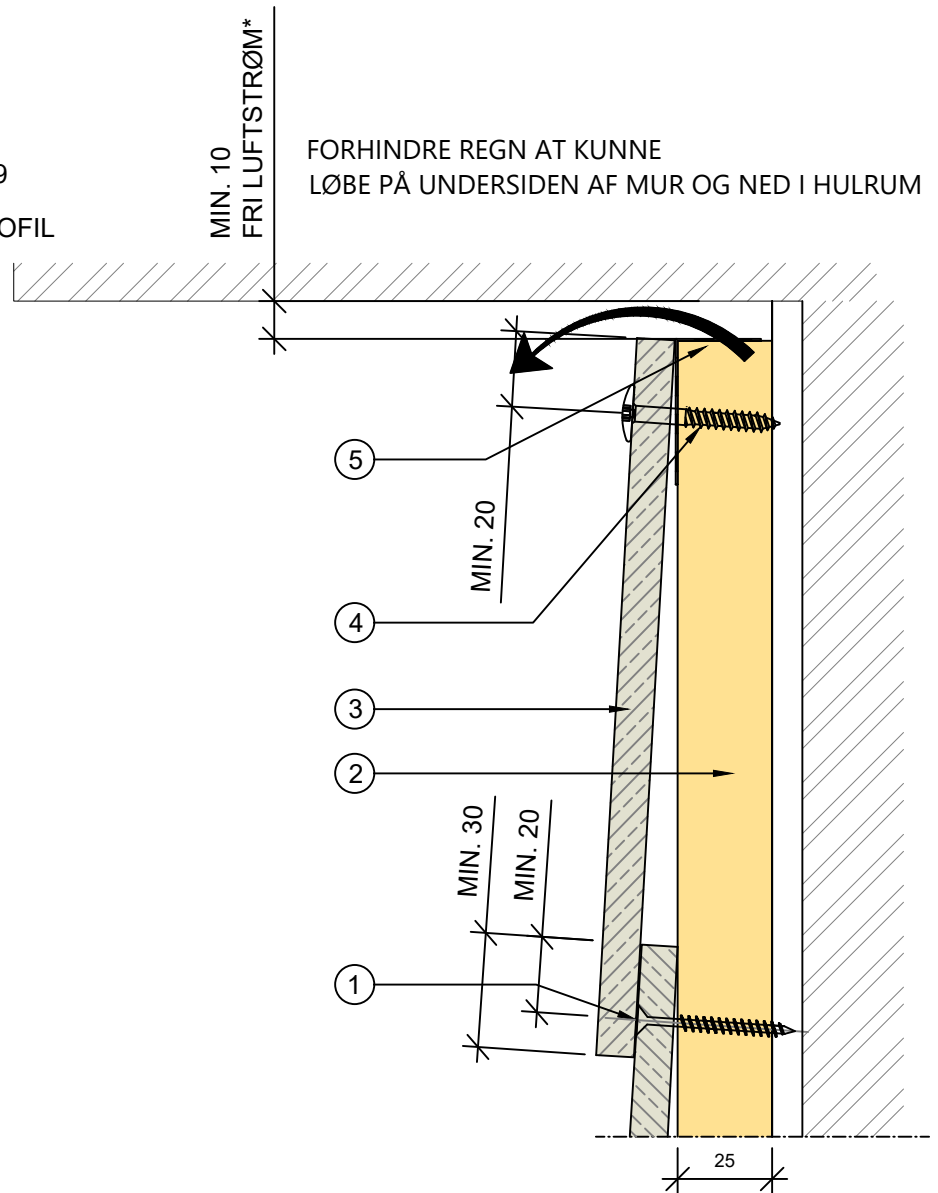

SEKTION 1:2

* FRI KONTINUERLIG LUFTSTRØM
MINIMUM 100 CM²/M KONTINUERLIG ÅBNING VED
INDLØBET/UDLØB - ANBEFALET FRI ÅBNING 10-15 MM

FOR YDERLIGERE INFORMATION, VENLIGST KONTAKT:

INTERNET: WWW.CEDRAL.WORLD E-MAIL: etexnordic-dk@etexgroup.com TEL: +45 73 66 19 99

ETEX NORDIC A/S, VENDERSGADE 74, DK-7000 FREDERICIA

CEDRAL

CEDRAL RITNING

CL 05A

DRAWING TITLE

TOP FACADE MOD UNDERBEKLÆDNING

AV

DKIVPF

DATUM

2022.01.16

SKALA

1:2

Copyright

This information is supplied in good faith but no liability can be accepted for any loss or damage resulting from use. All details and quantities must be checked and approved prior to order.

- ① SQD SKRUE 4,2x45 [4034483]
- ② AFSTANDSLISTE 25x100/25x50
- ③ CEDRAL LAP
- ④ SYNLIG I-FIX TRÆSKRUE 4,8x39
- ⑤ PERFORERT VENTILATIONSPROFIL [4017076, 4017078]
- ⑥ CEDRAL BOARD

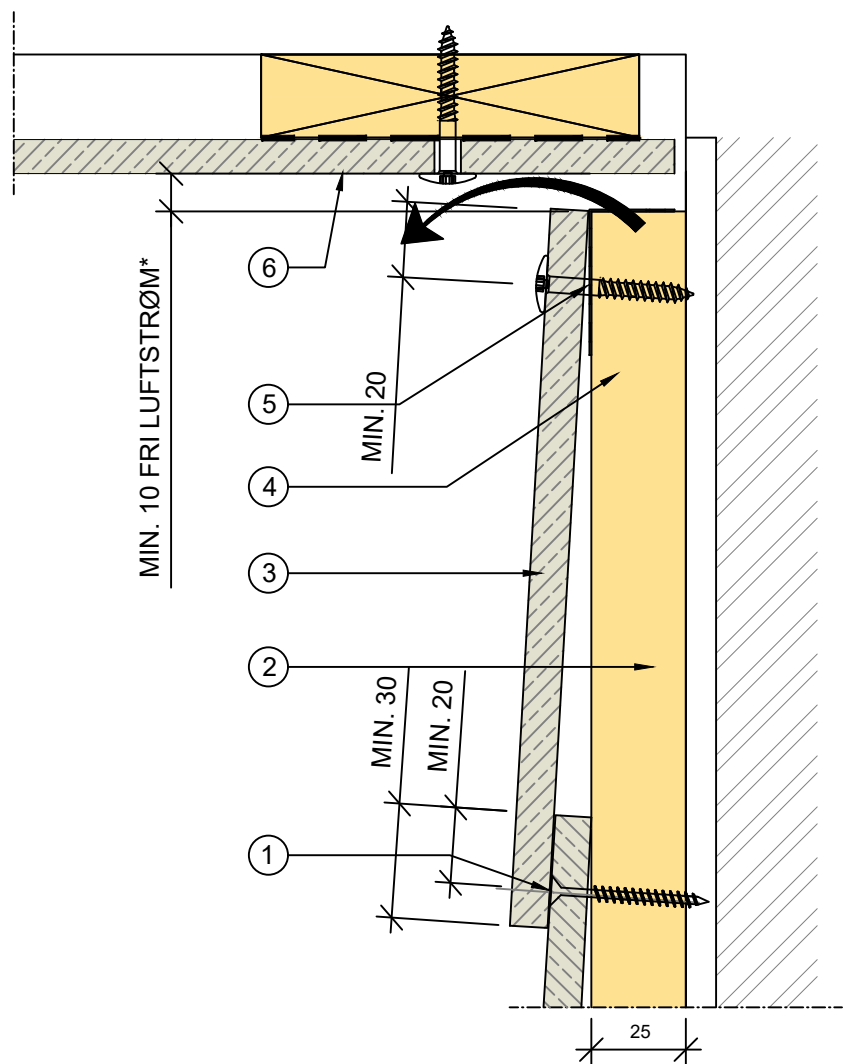

SEKTION 1:2

* FRI KONTINUERLIG LUFTSTRØM
MINIMUM 100 CM²/M KONTINUERLIG ÅBNING VED
INDLØBET/UDLØB - ANBEFALET FRI ÅBNING 10-15 MM

FOR YDERLIGERE INFORMATION, VENLIGST KONTAKT:

INTERNET: WWW.CEDRAL.WORLD E-MAIL: etexnordic-dk@etexgroup.com TEL: +45 73 66 19 99

ETEX NORDIC A/S, VENDERSGADE 74, DK-7000 FREDERICIA

- ① SQD SKRUE 4,2x45 [4034483]
- ② AFSTANDSLISTE 25x100
- ③ EPDM BÅND [4087325] - DÆK HELE AFSTANDSLISTE
- ④ CEDRAL LAP

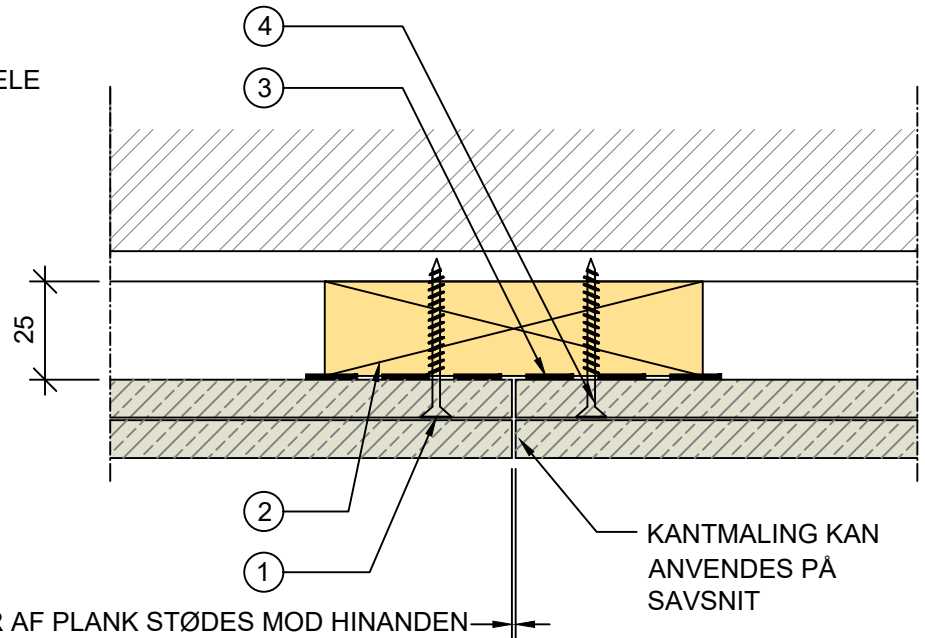

SAMMENFALDENE FUGER PLAN 1:2

- ① SQD SKRUE 4,2x45 [4034483]
- ② AFSTANDSLISTE 25x100
- ③ EPDM BÅND [4087325] - LÆNGDE 200 MM
- ④ CEDRAL LAP

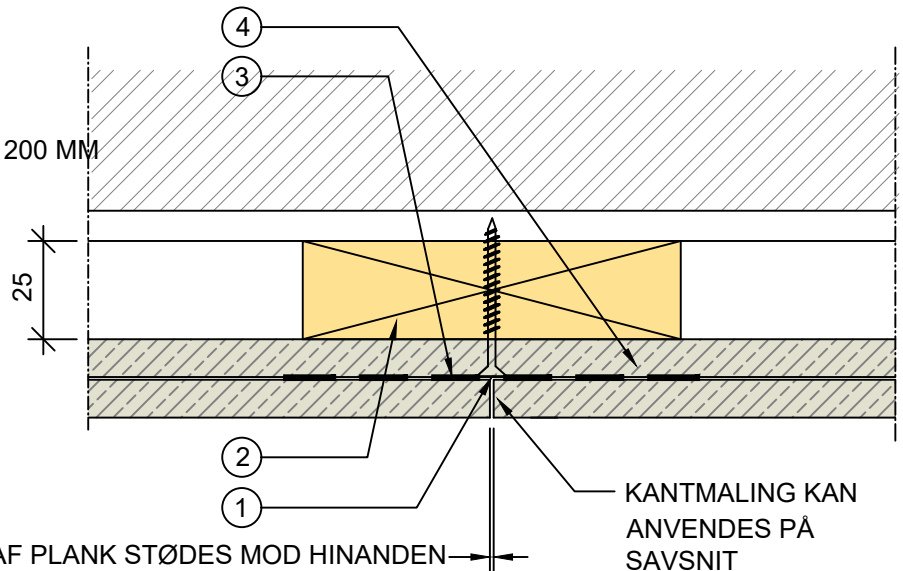

FUGER I FORBANDT PLAN 1:2

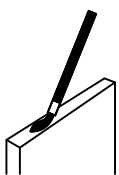

CEDRAL KANTMALING KAN ANVENDES PÅ SAVSNIT MED EN LILLE PENSEL
 BEHANDLE SAVSNIT MED SANDPAPIR P80, TØR OG REN OVERFLADE
 TEMPERATUR IKKE UNDER 7 GRADER
 PLANKERNE ER FABRIKSMÅLET, HVORFOR PENSELMALING PÅ FRONTEN VIL BLIVE SYNLIG

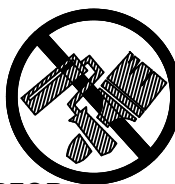

CEDRAL

CEDRAL TEGNING

CL 07

TITEL

SYMETRISK UDVENDIGT HJØRNE

AF

DKIVPF

DATO

2023.01.24

SKALA

1:2

Copyright

This information is supplied in good faith but no liability can be accepted for any loss or damage resulting from use. All details and quantities must be checked and approved prior to order.

- ① SYMETRISK UDVENDIGT HJØRNE
- ② CEDRAL LAP
- ③ EPDM BÅND [4087325]
- ④ SQD SKRUE 4,2x45 [4034483]
- ⑤ AFSTANDSLISTE 25x100/25x50
- ⑥ MONTERINGSSKRUE ELLER SØM

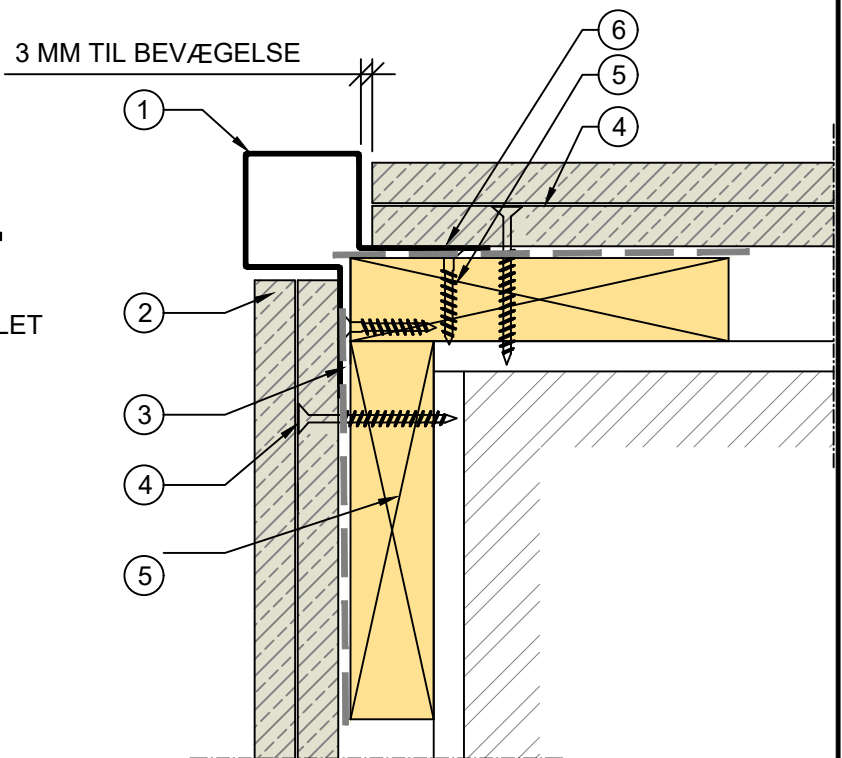
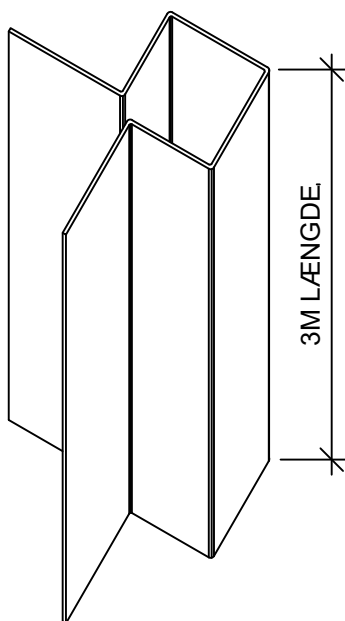
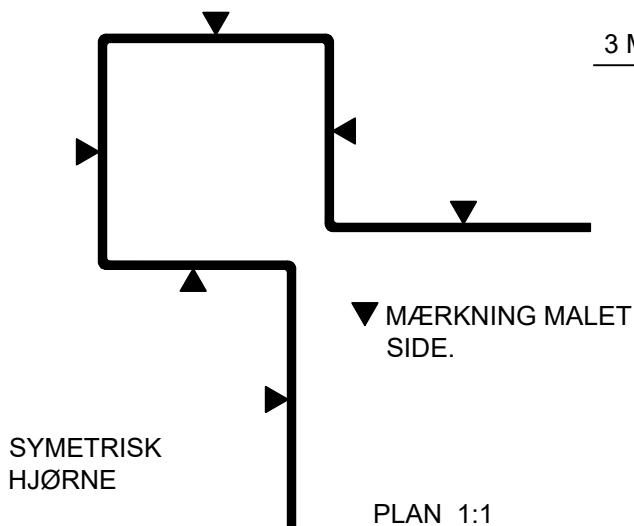

FOR YDERLIGERE INFORMATION, VENLIGST KONTAKT:
INTERNET: WWW.CEDRAL.WORLD E-MAIL: etexnordic-dk@etexgroup.com TEL: +45 73 66 19 99
ETEX NORDIC A/S, VENDERSGADE 74, DK-7000 FREDERICIA

CEDRAL

CEDRAL TEGNING

CL 08

TITEL

SIDEINDDÆKNING VINDUE

AF

DKIVPF

DATO

2023.01.24

SKALA

1:2

Copyright

This information is supplied in good faith but no liability can be accepted for any loss or damage resulting from use. All details and quantities must be checked and approved prior to order.

- ① SIDINDDÆKNING PROFIL CEDRAL LAP
- ② EPDM BÅND [4087325]
- ③ SQD SKRUE 4,2x45 [4034483]
- ④ AFSTANDSLISTE 25x100/25x50
- ⑤ MONTERINGSSKRUE ELLER SØM
- ⑥ CEDRAL LAP

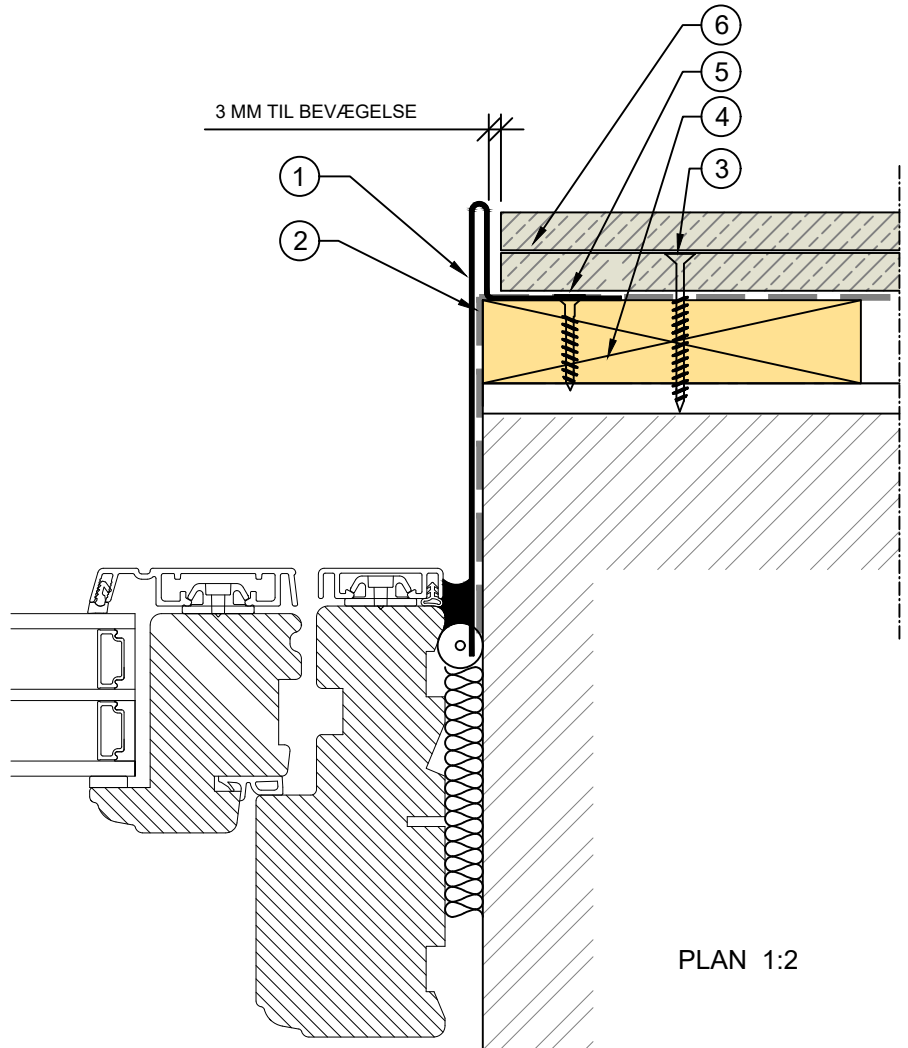
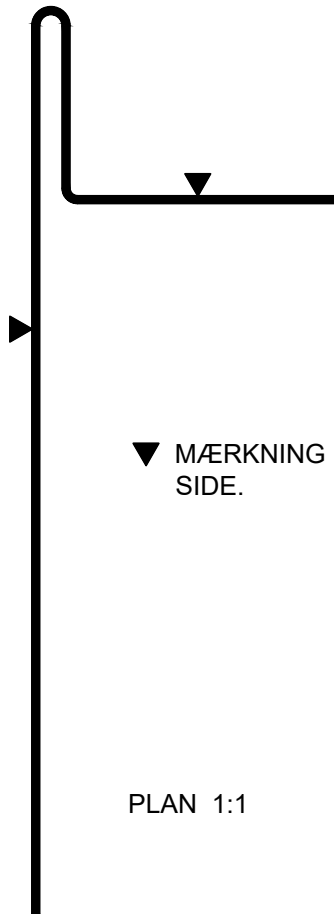

FOR YDERLIGERE INFORMATION, VENLIGST KONTAKT:

INTERNET: WWW.CEDRAL.WORLD E-MAIL: etexnordic-dk@etexgroup.com TEL: +45 73 66 19 99

ETEX NORDIC A/S, VENDERSGADE 74, DK-7000 FREDERICIA

- ① ASSYMETRISK UDVENDIGT HJØRNE
- ② EPDM BÅND [4087325]
- ③ SYNLIG I-FIX TRÆSKRUE 4,8x39
- ④ ENKEL ENDEKANT PROFIL
- ⑤ SELVKLÆBENDE TÆTNINGSBÅND
- ⑥ SQD SKRUE 4,2x45 [4034483]
- ⑦ AFSTANDSLISTE 25x100/25x50
- ⑧ MONTERINGSSKRUE ELLER SØM

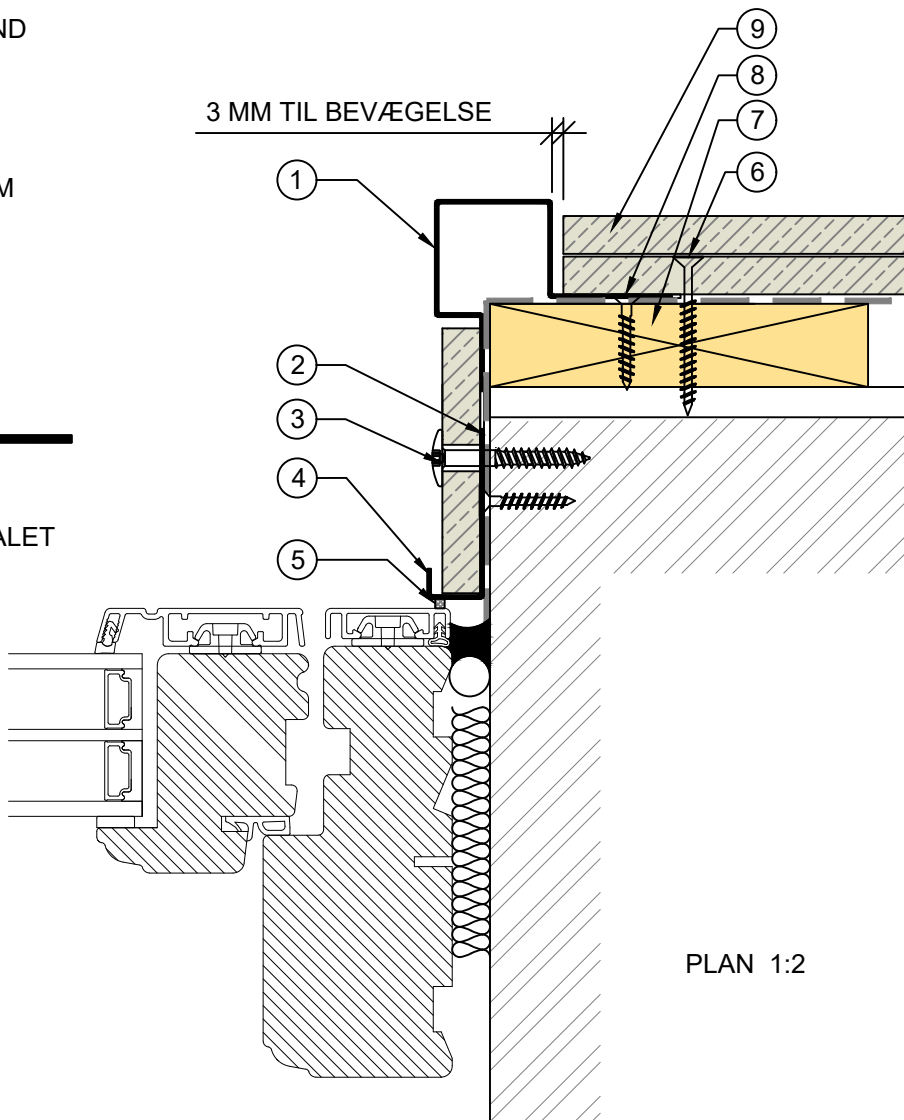
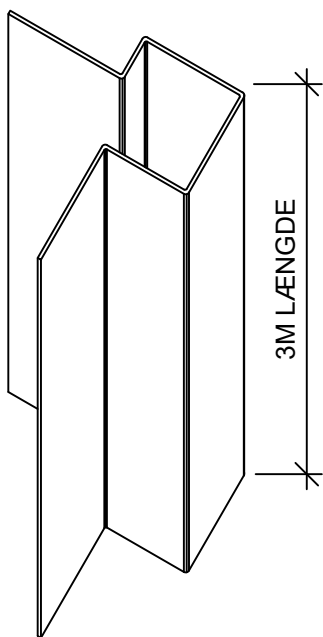
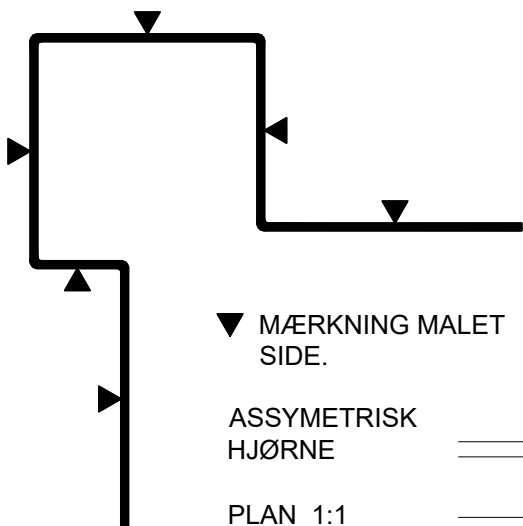

- ① CEDRAL LAP
- ② AFSTANDSLISTE 25x100/25x50
- ③ EPDM BÅND [4087325]
- ④ SQD SKRUE 4,2x45 [4034483]
- ⑤ INVENDIGT HJØRNE PROFIL

▼ MÆRKNING MALET
SIDE.

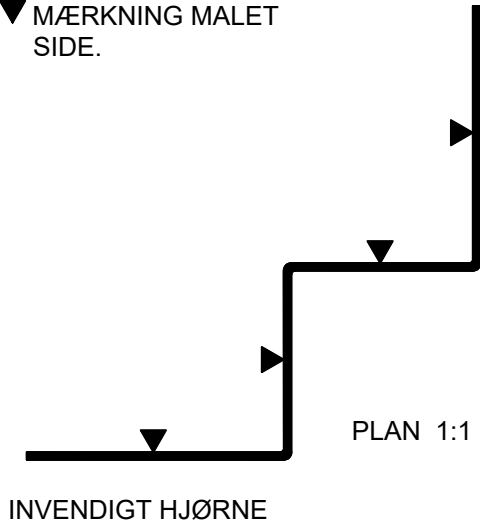

INVENDIGT HJØRNE

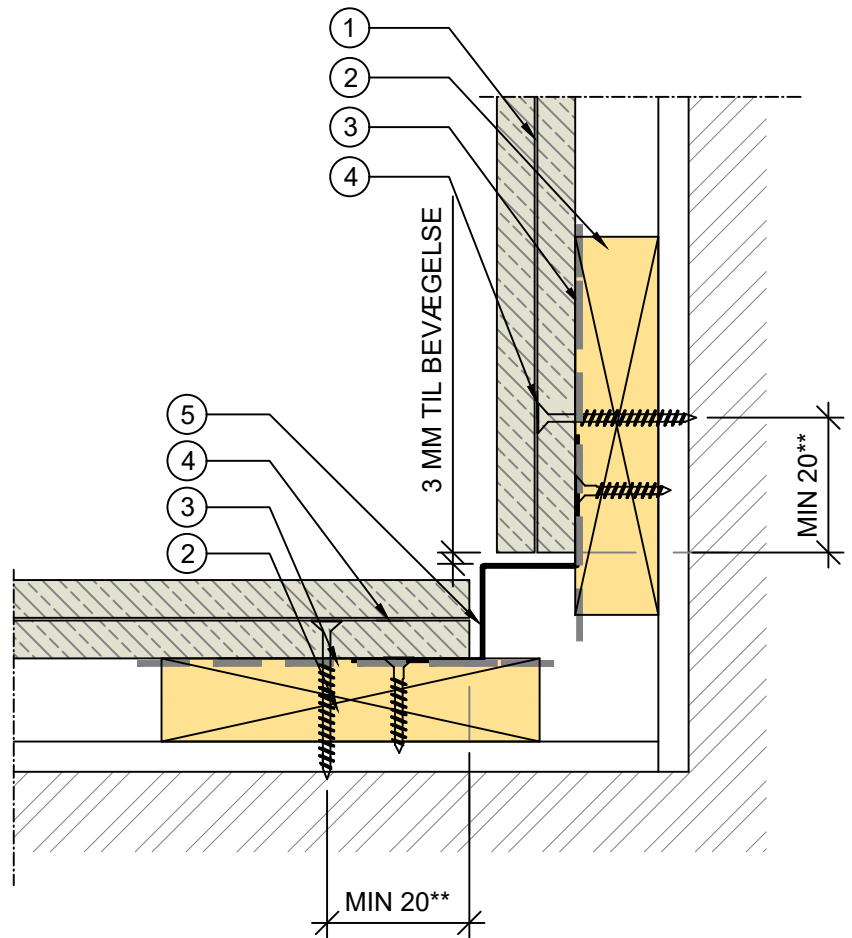
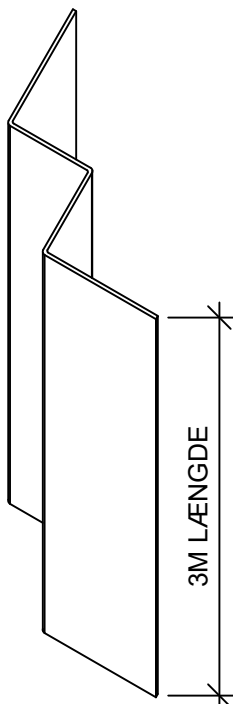

** SKRUE MONTERES VED
SIDEN AF PROFIL

PLAN 1:2

FOR YDERLIGERE INFORMATION, VENLIGST KONTAKT:

INTERNET: WWW.CEDRAL.WORLD E-MAIL: etexnordic-dk@etexgroup.com TEL: +45 73 66 19 99

ETEX NORDIC A/S, VENDERSGADE 74, DK-7000 FREDERICIA

- ① CEDRAL LAP
- ② AFSTANDSLISTE 25x100/25x50
- ③ EPDM BÅND [4087325]
- ④ SQD SKRUE 4,2x45 [4034483]
- ⑤ DOBBELT ENDEKANT PROFIL
- ⑥ SELVKLÆBENDE TÆTNINGSBÅND

▼ MÆRKNING MALET SIDE.

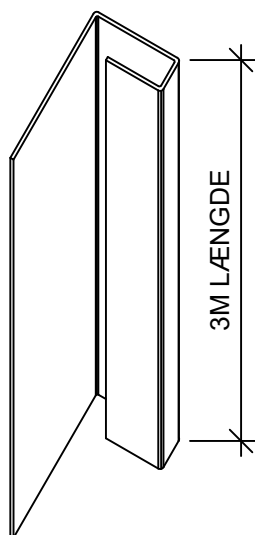
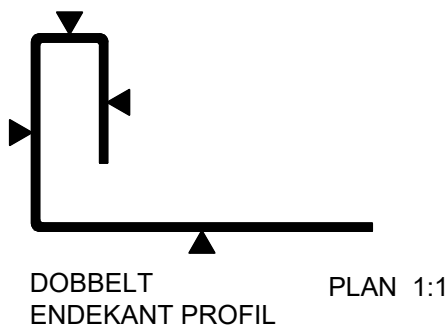

** SKRUE MONTERES VED SIDEN AF PROFIL

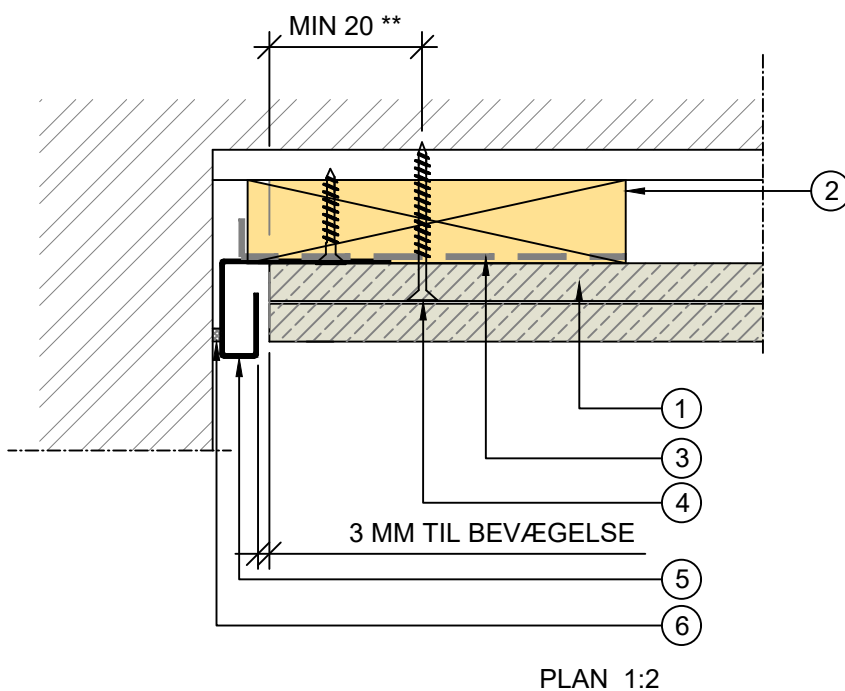

FOR YDERLIGERE INFORMATION, VENLIGST KONTAKT:

INTERNET: WWW.CEDRAL.WORLD E-MAIL: etexnordic-dk@etexgroup.com TEL: +45 73 66 19 99

ETEX NORDIC A/S, VENDERSGADE 74, DK-7000 FREDERICIA

Copyright

This information is supplied in good faith but no liability can be accepted for any loss or damage resulting from use. All details and quantities must be checked and approved prior to order.

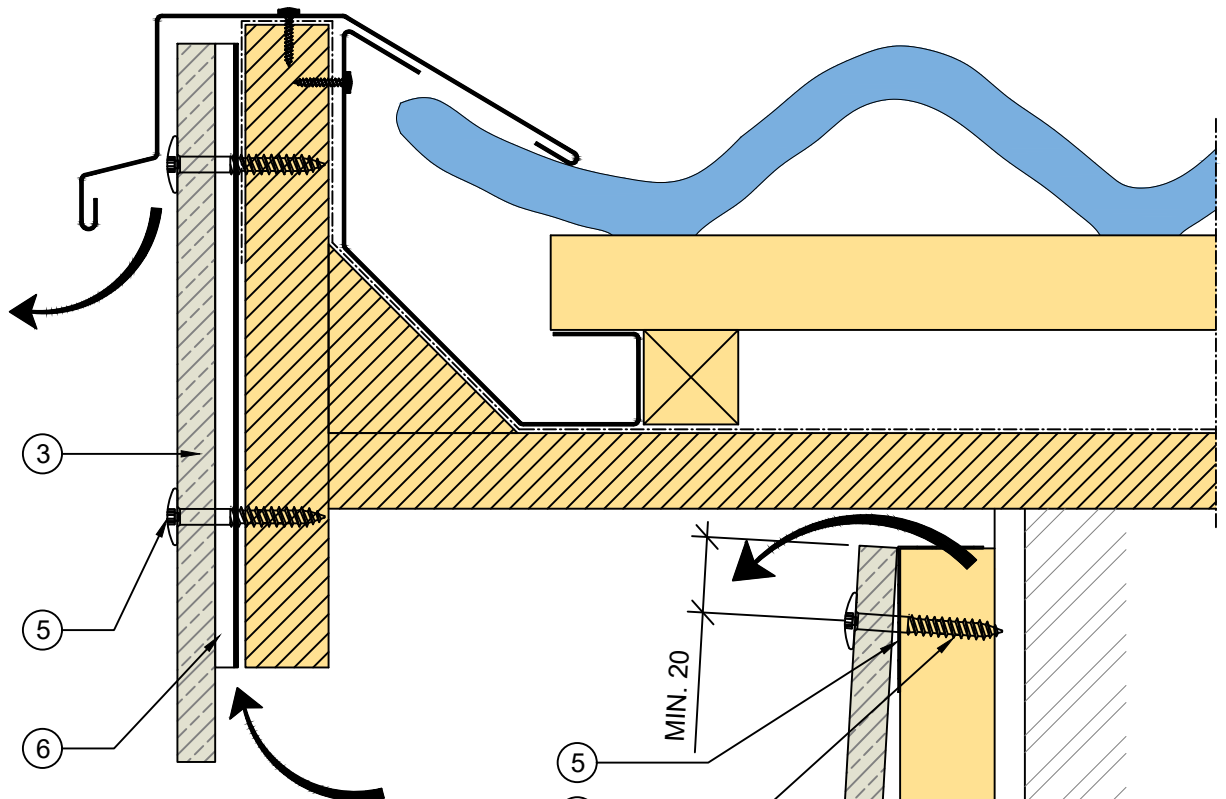

- ① SQD SKRUE 4,2x45 [4034483]
- ② AFSTANDSLISTE 25x100/25x50
- ③ CEDRAL LAP
- ④ SYNLIG I-FIX TRÆSKRUE 4,8x39
- ⑤ PERFORERT VENTILATIONSPROFIL [4017076, 4017078]
- ⑥ 6MM VENTILATIONSPROFIL PVC B=70MM [4009296]

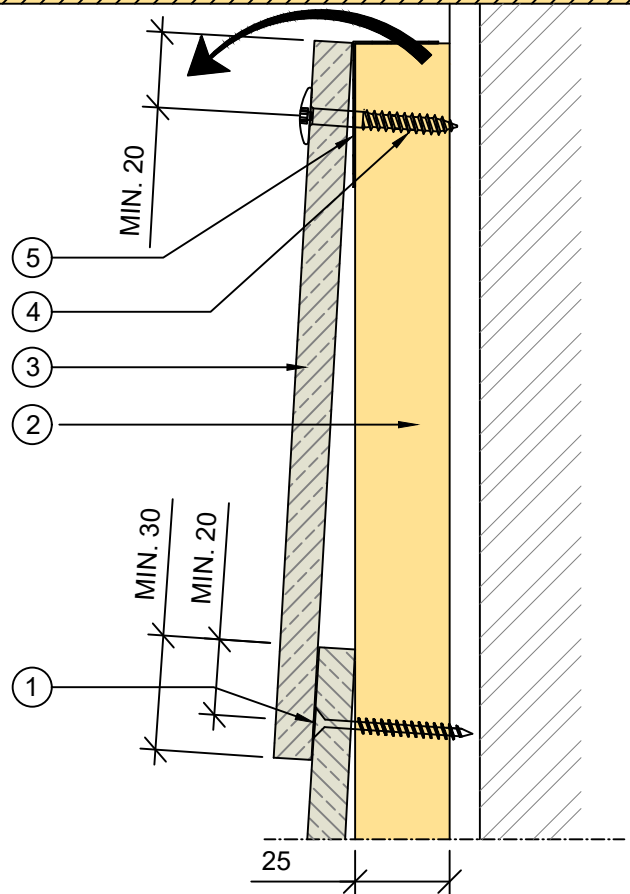

VENTILATIONSPROFIL PVC

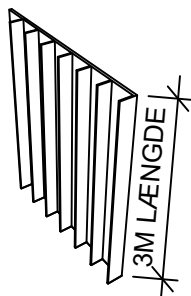

FOR YDERLIGERE INFORMATION, VENLIGST KONTAKT:

INTERNET: WWW.CEDRAL.WORLD E-MAIL: etexnordic-dk@etexgroup.com TEL: +45 73 66 19 99

ETEX NORDIC A/S, VENDERSGADE 74, DK-7000 FREDERICIA

Copyright

This information is supplied in good faith but no liability can be accepted for any loss or damage resulting from use. All details and quantities must be checked and approved prior to order.

- ① SQD SKRUE 4,2x45 [4034483]
- ② AFSTANDSLISTE 25x100/25x50
- ③ CEDRAL LAP
- ④ I-FIX TRÆSKRUE 4,8x39
- ⑤ VINDSKEDE M. UDLUFTNING IKKE ETEX PRODUKT

OBS!
PROFIL SKAL VARE UDFORT MED
UDLUFTNINGSHULLER
UDLUFTNINGSAREAL MIN. 100 CM²/M
FORHAEDELS IKKE AF ETEX

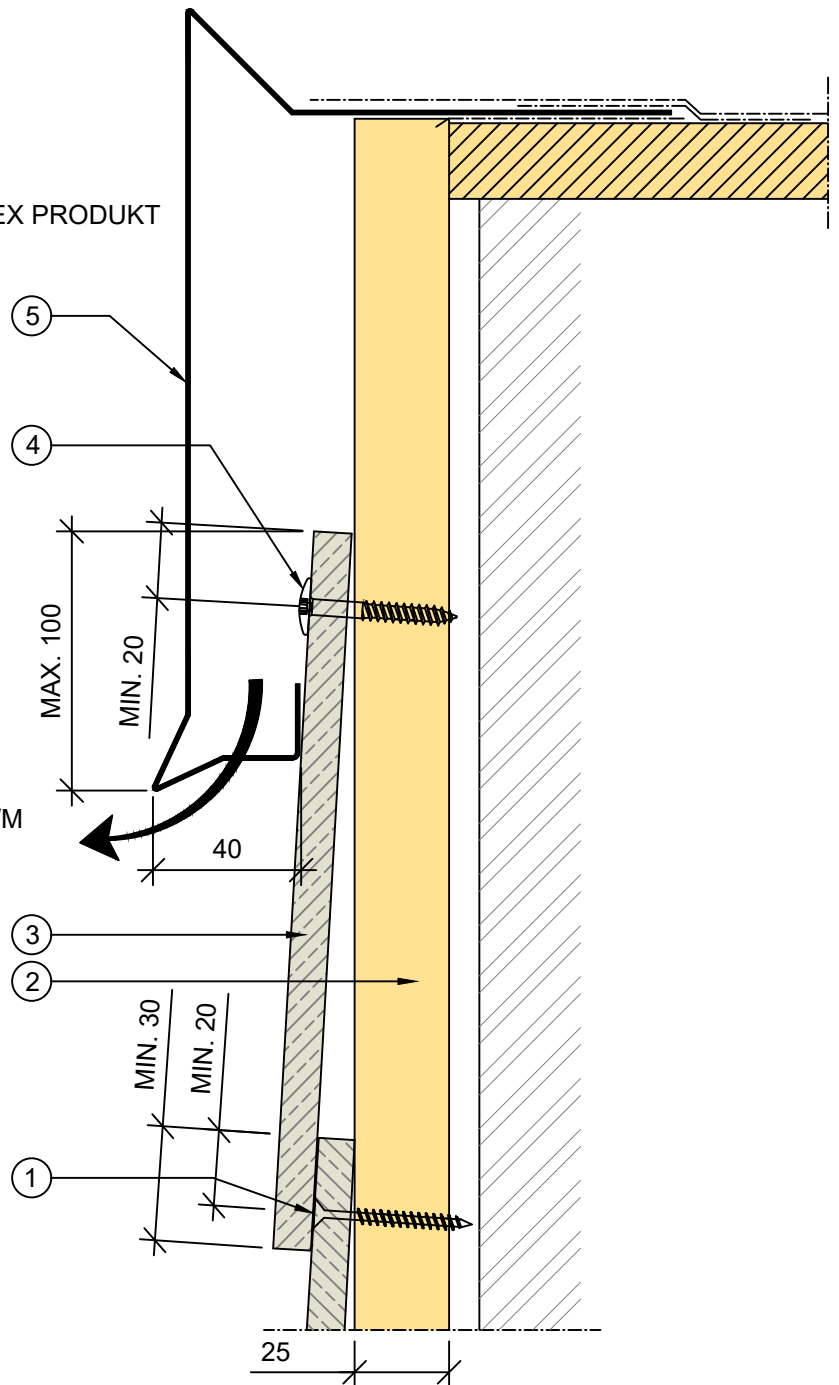

SEKTION 1:2

Copyright

This information is supplied in good faith but no liability can be accepted for any loss or damage resulting from use. All details and quantities must be checked and approved prior to order.

- ① SQD SKRUE 4,2x45 [4034483]
- ② AFSTANDSLISTE 25x100/25x50
- ③ CEDRAL LAP
- ④ I-FIX TRÆSKRUE 4,8x39
- ⑤ PERFORERT VENTILATIONSPROFIL [4017076, 4017078]
- ⑥ EKSTRA AFSTANDSLISTE 38x73
- ⑦ VINDSKEDE IKKE ETEX PRODUKT
OBS!
PROFIL FORHANDLES IKKE AF ETEX

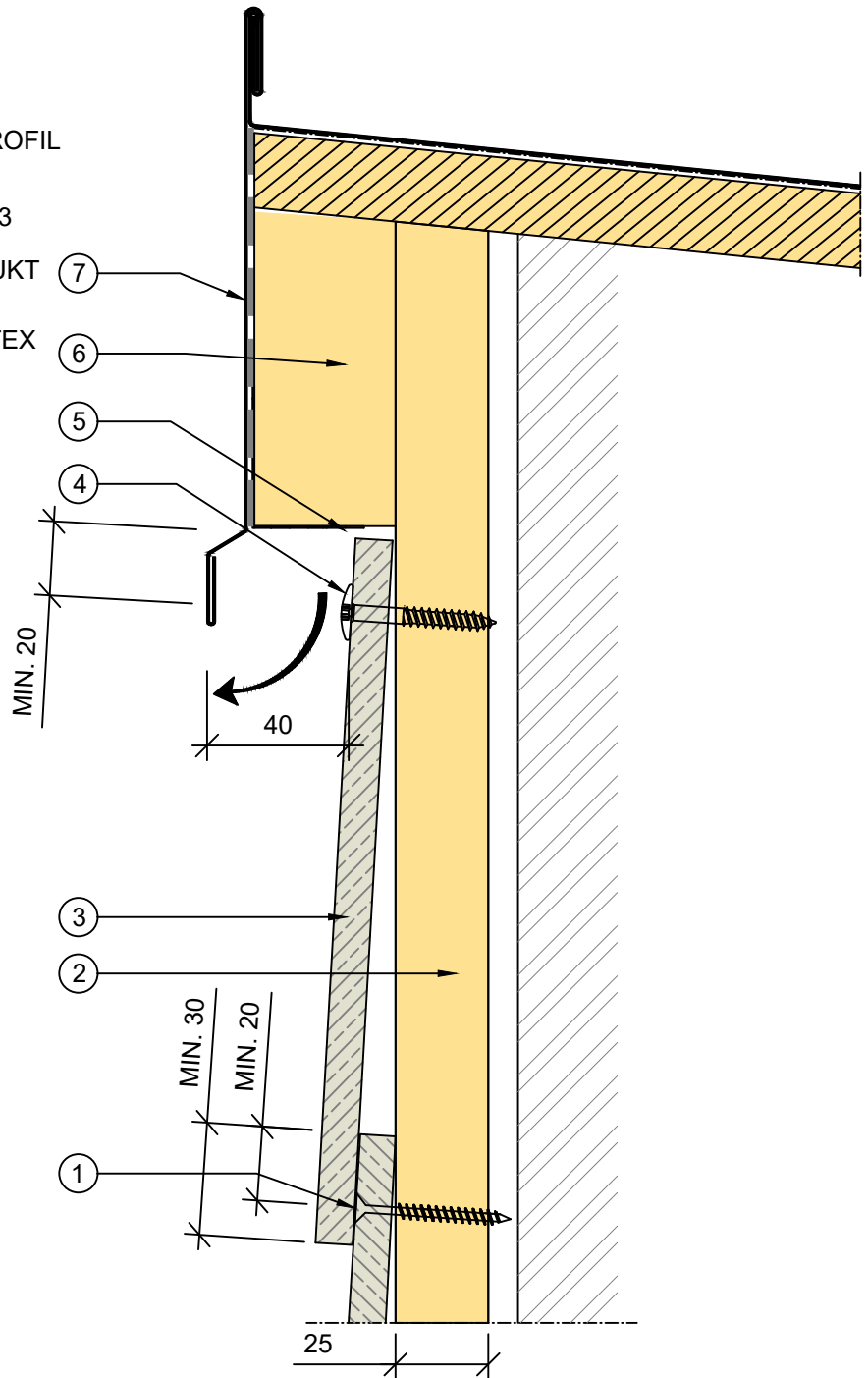

SEKTION 1:2

FOR YDERLIGERE INFORMATION, VENLIGST KONTAKT:

INTERNET: WWW.CEDRAL.WORLD E-MAIL: etexnordic-dk@etexgroup.com TEL: +45 73 66 19 99

ETEX NORDIC A/S, VENDERSGADE 74, DK-7000 FREDERICIA